

# G25-Installation Instructions

(Please refer to the installation video on the product link, or the installation video on YouTube)

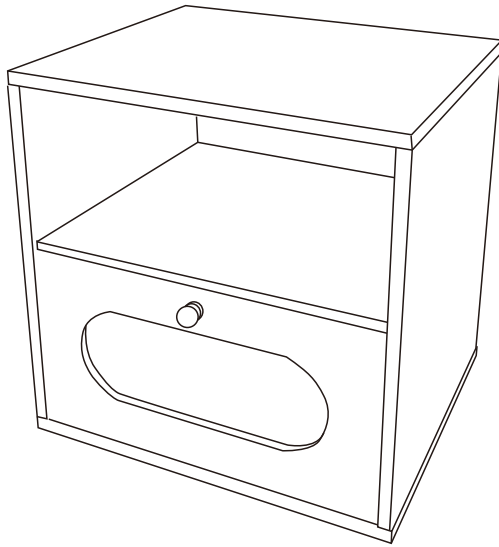

Dear customer, Thanks for your order.  
If you have any questions.  
please feel free to contact us directly.

## package Included

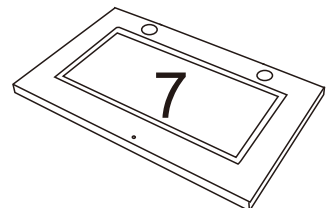
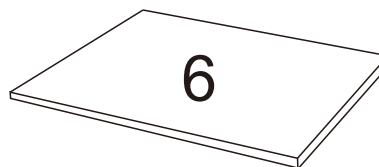
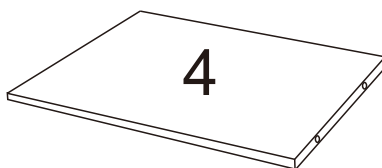
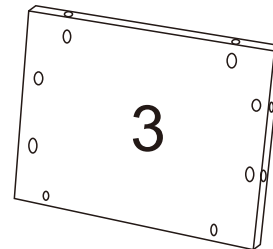
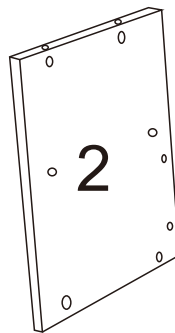
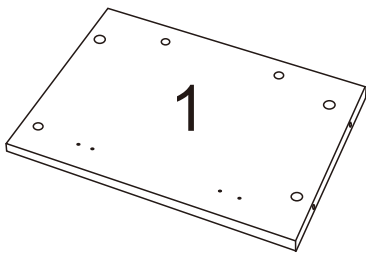

# package Included

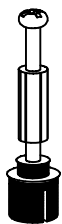

A\*20



B\*20



C\*12

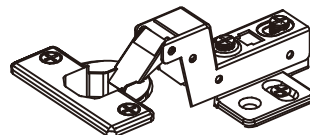

D\*2



E\*1



F\*1



J\*1

The supplied parts correspond to the quantity required for a single cabinet

If the door is uneven once assembled, you can adjust the hinges like following

Adjust left

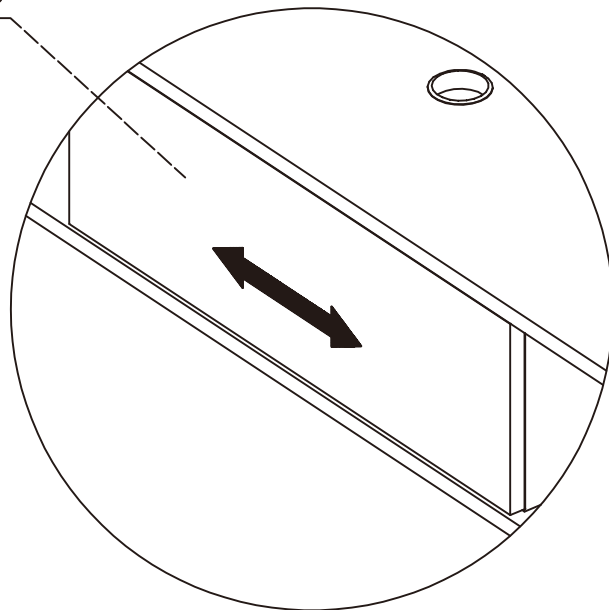
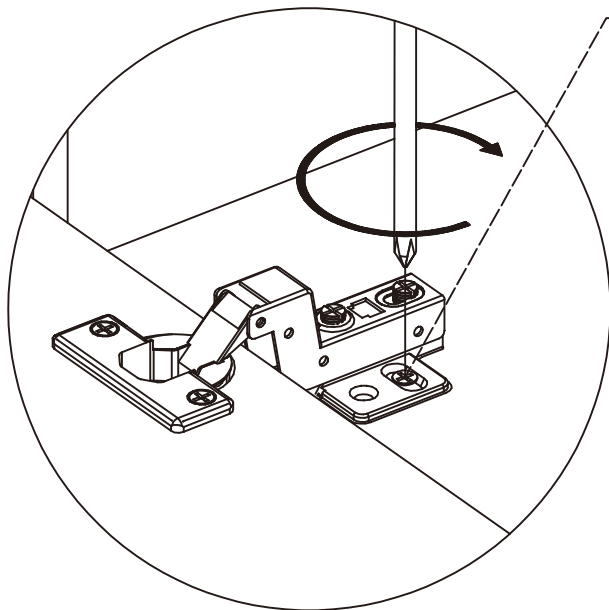

Adjust Height

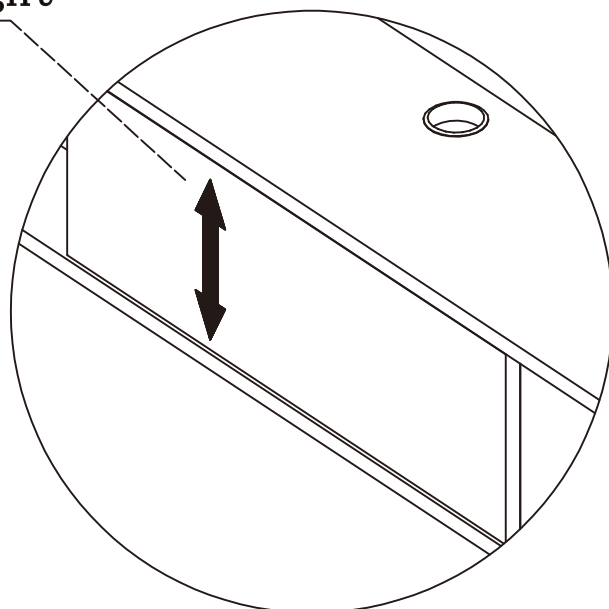
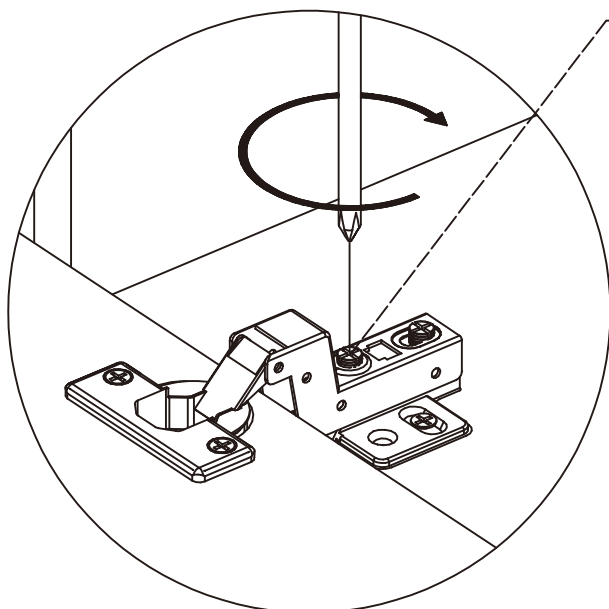

Adjust front

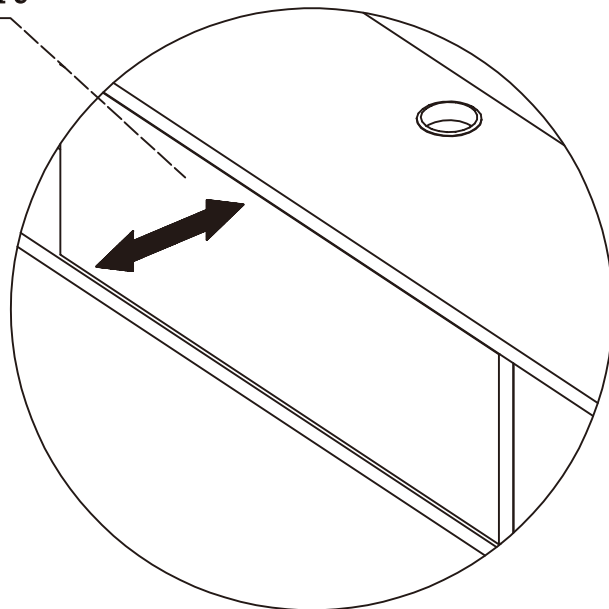
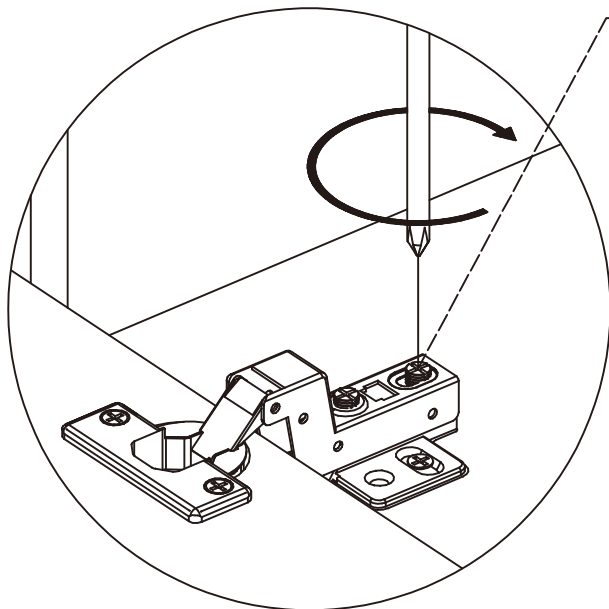

## Tools Included

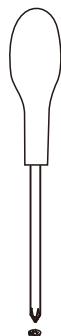

### How to adjust the door hinge/hinge.

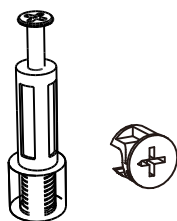
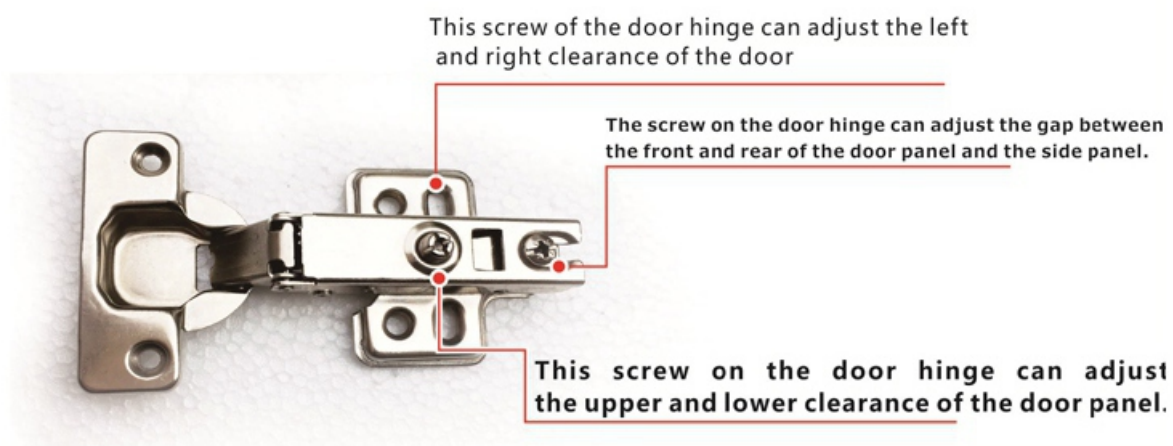

3-in-1 fastener screws

Unscrew it to the left  
and screw it to the right

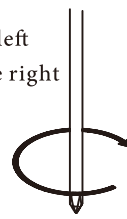

put the 3-in-1 screws into  
the pre-holes and then screw  
them with screwdriver or power screwdriver

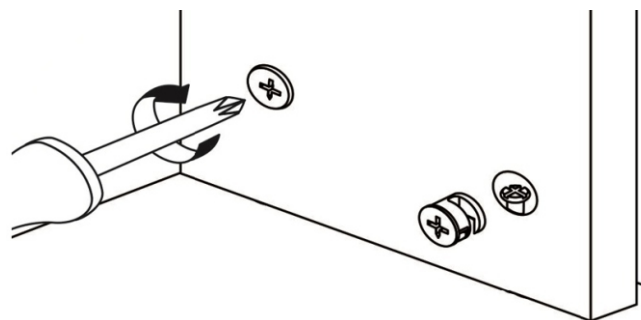
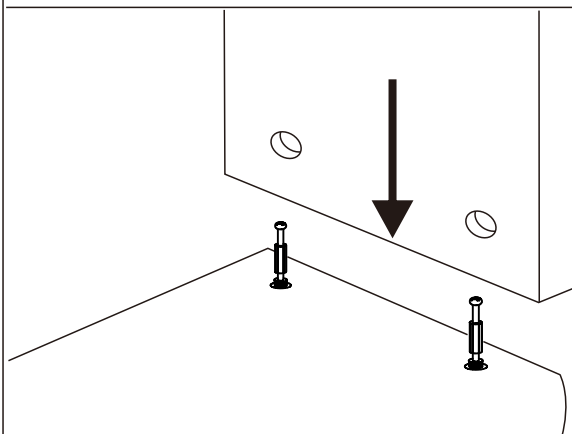

put the fasteners into the holes and  
screw it with a screwdriver

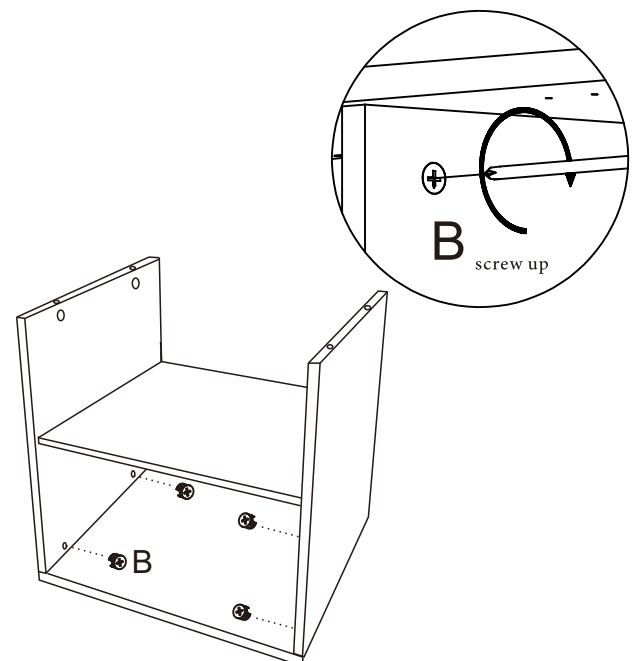
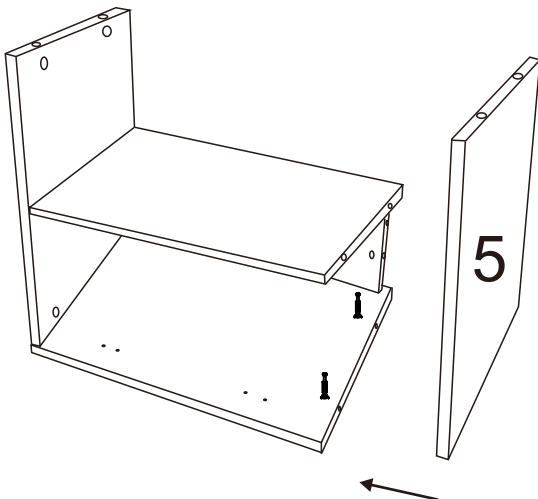
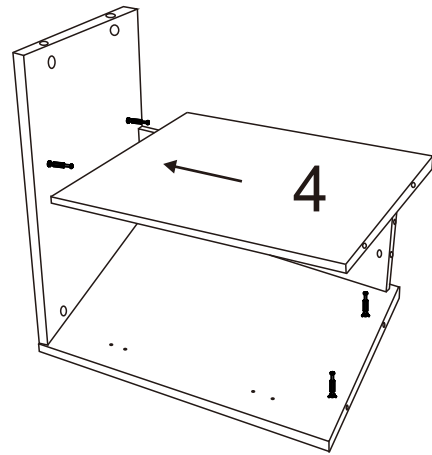
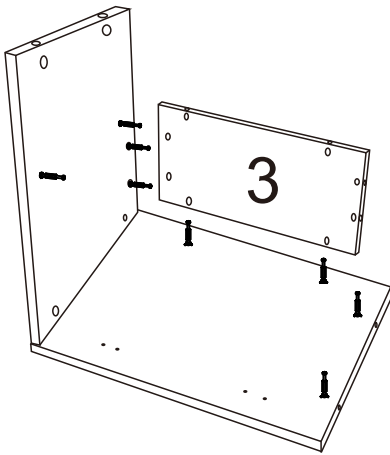
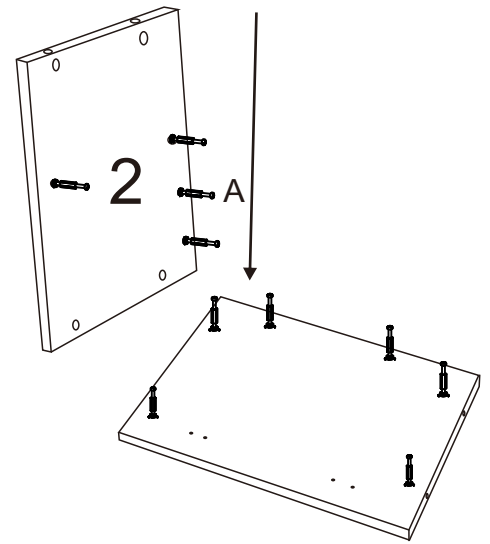
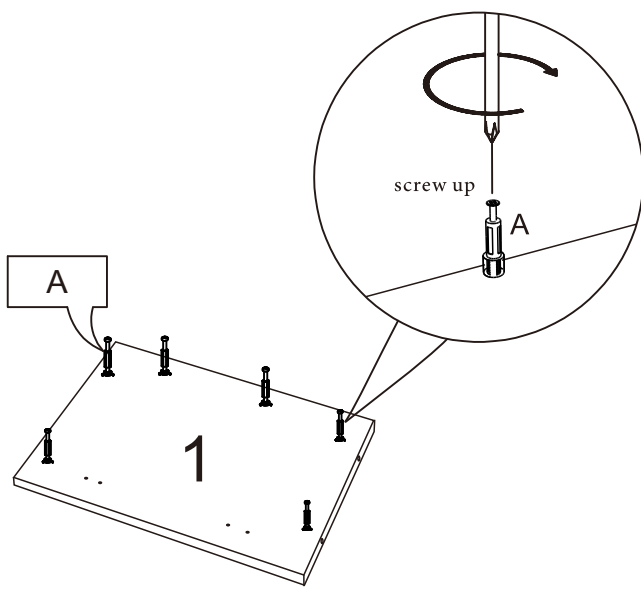

The gap of accessory B needs to be aligned with the screw

