

A41-Installation Instructions

(Please refer to the installation video on the product link, or the installation video on YouTube,
or feel free to contact us directly on Amazon.)

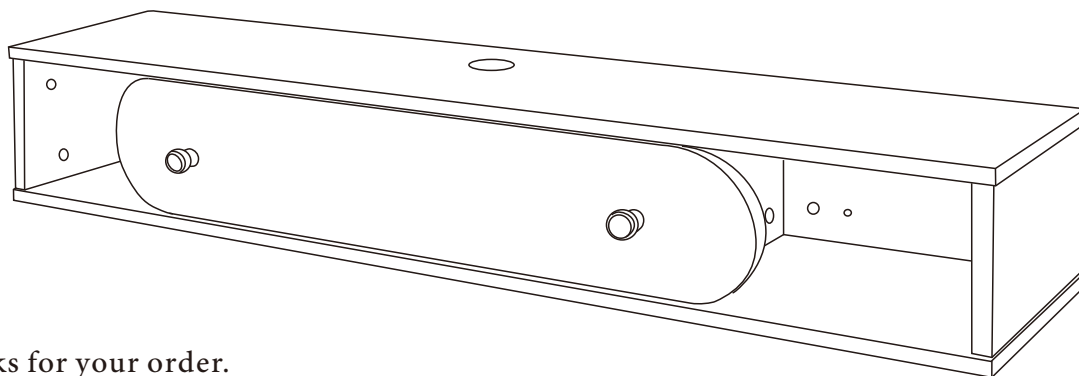

Dear customer, Thanks for your order.
If you have any questions.
please feel free to contact us directly.

Included 8mm screws and anchors
for solid brick walls.
load-bearing walls.
and fired hollow brick walls

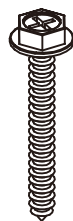

If you have drywall, please use the
18mm drill bit(not included) and the
toggle bolts for mounting (package included).
Follow the steps below for mounting on the drywall

- Step 1: Drill 18mm hole on the drywall
- Step 2: Getting through the pre-holes of the tv stand with G & H
- Step 3: Put the Wing Nut on the Toggle Bolt (G) and then pass it through the hole of the drywall
- Step 4: Put all the toggle bolts and butts into the drywall
- Step 5: Screw up all the toggle bolts

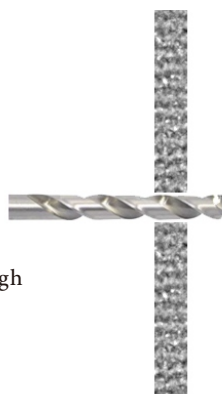

step1



step2

Recommended Number of People for Assembly 2.

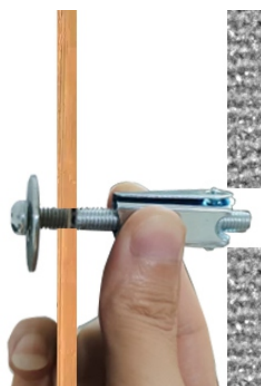

step3

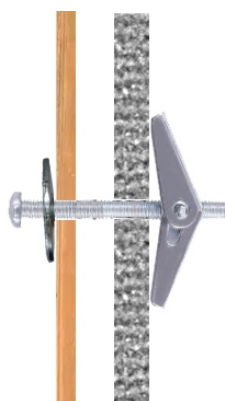

step4

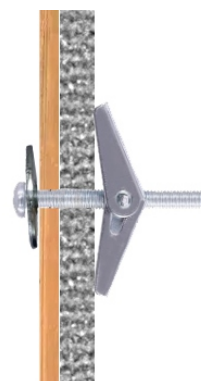

step5

Tools Included

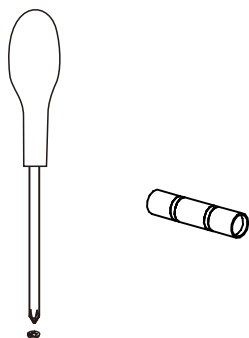

Tools Required



How to adjust the door hinge/hinge.

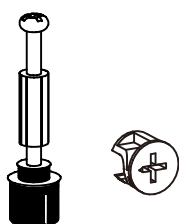
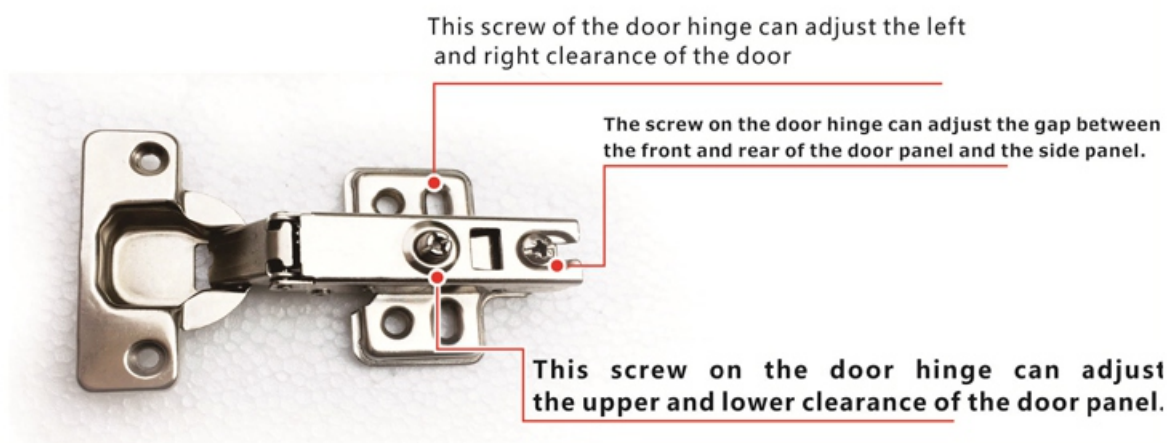

3-in-1 fastener screws

Unscrew it to the left and screw it to the right

put the 3-in-1 screws into the pre-holes and then screw them with screwdriver or power screwdriver

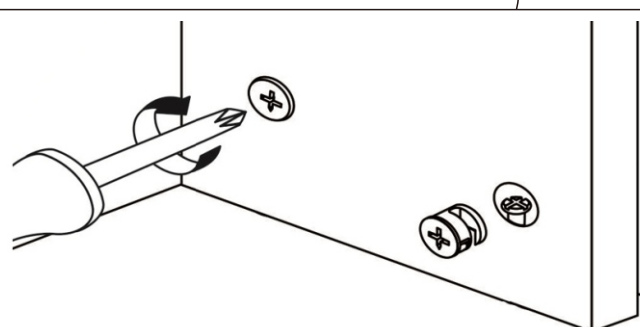
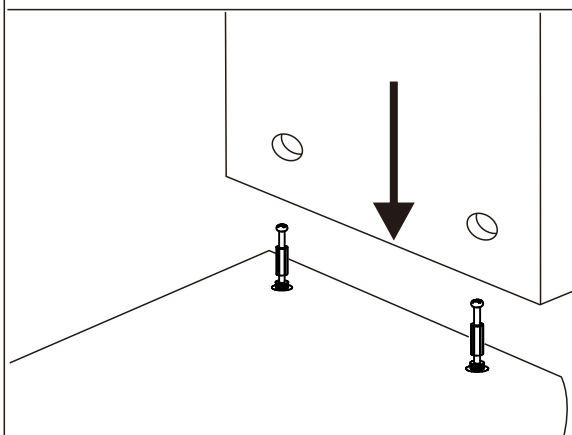

put the fasteners into the holes and screw it with a screwdriver

If the door is uneven once assembled, you can adjust the hinges like following

Adjust left

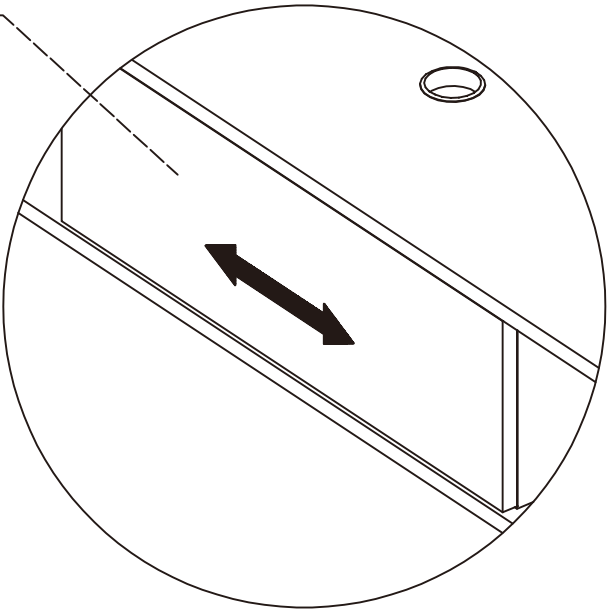
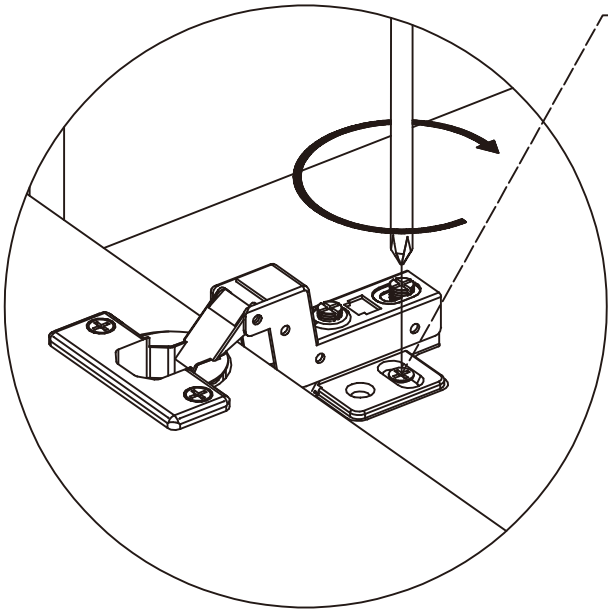

Adjust Height

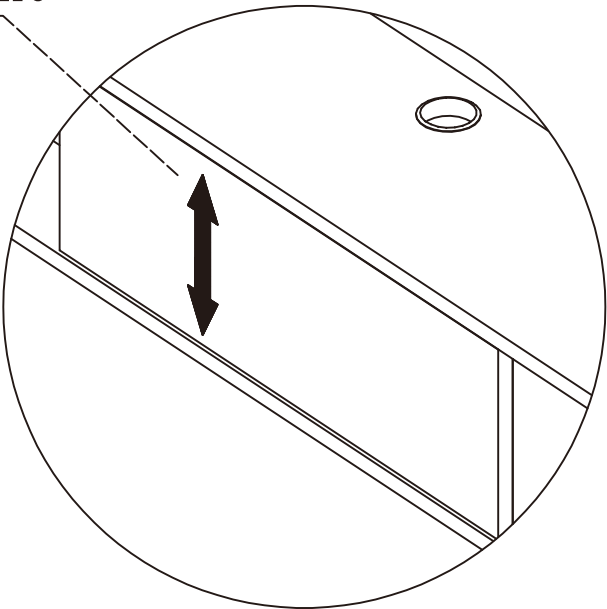
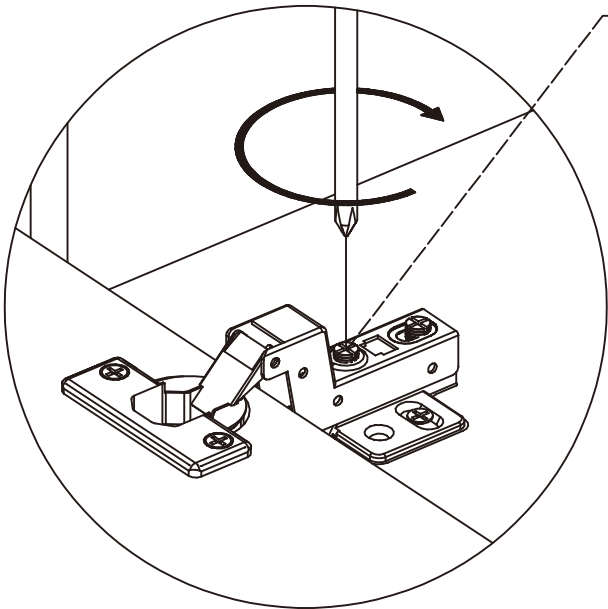

Adjust front

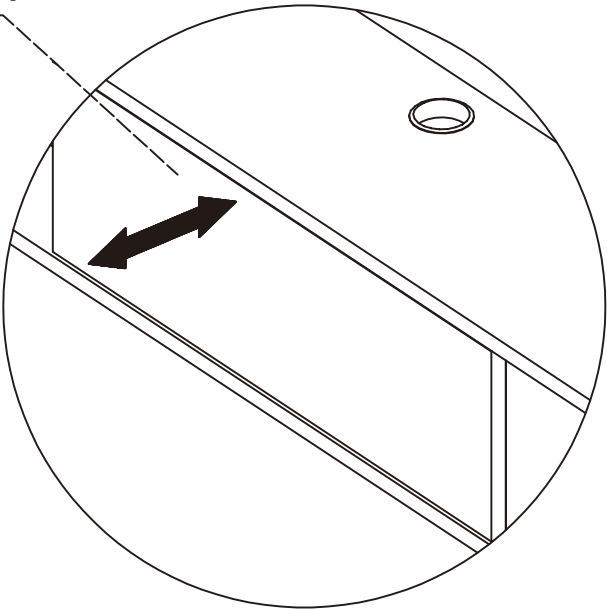
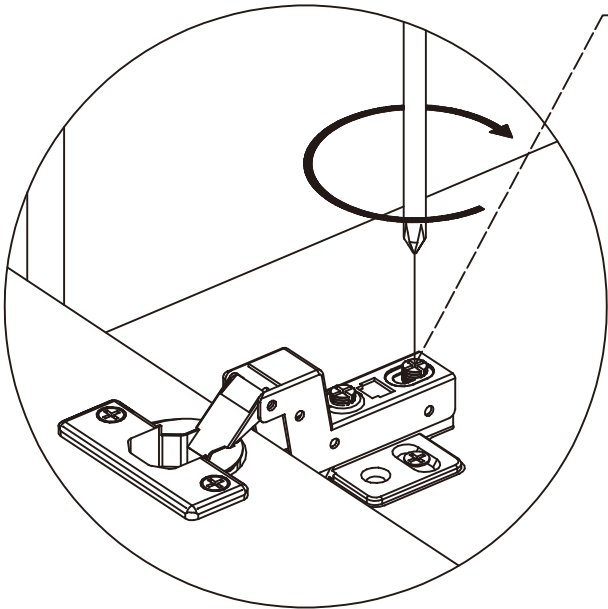

package Included

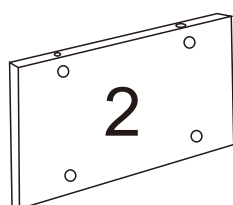
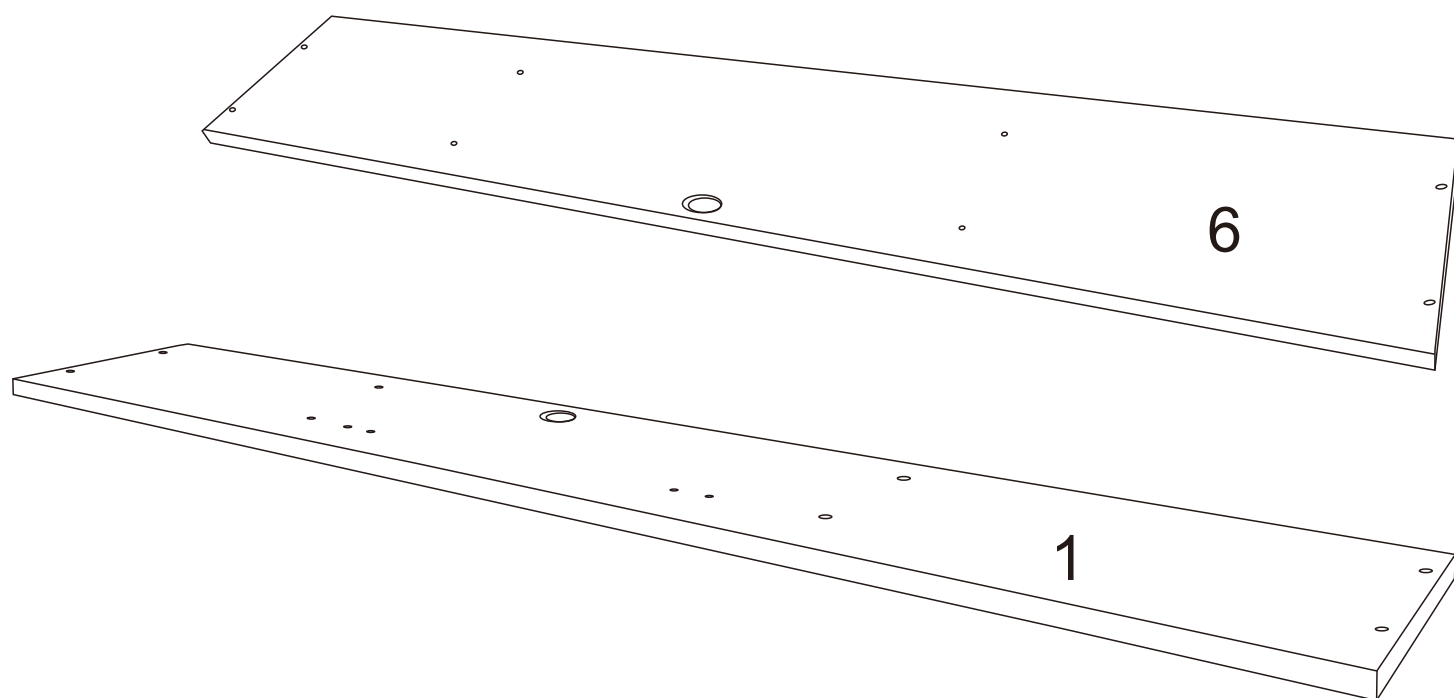

2*2

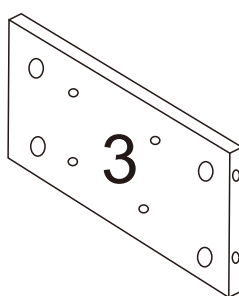

3*2

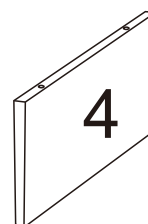

4*2

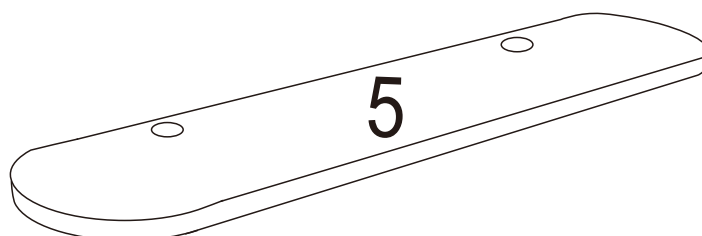

5*1

package Included

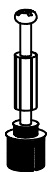

A*24



B*24



C*12

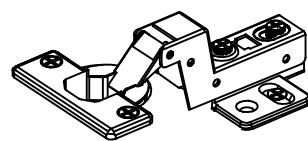

D*2



E*8

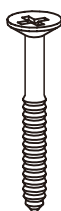

F*8

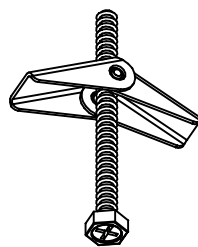

G*8



H*8



I*2



J*2



K*2

Make sure Screw up all the screws

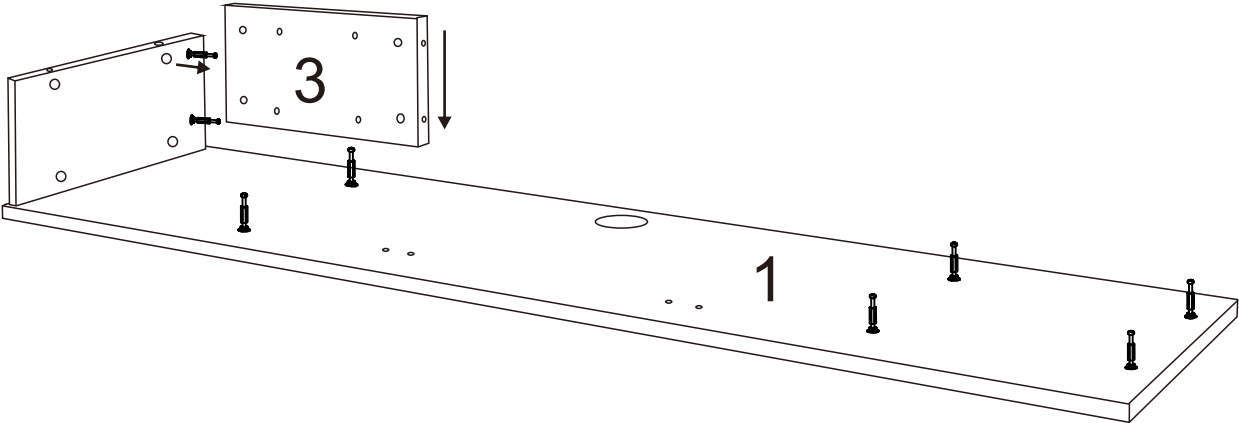
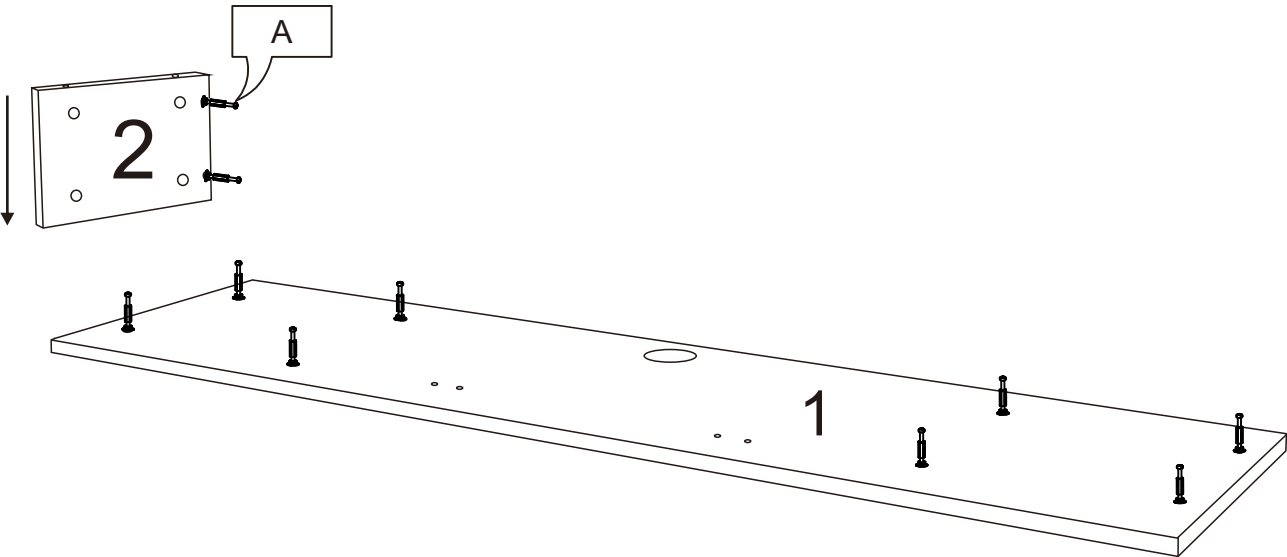
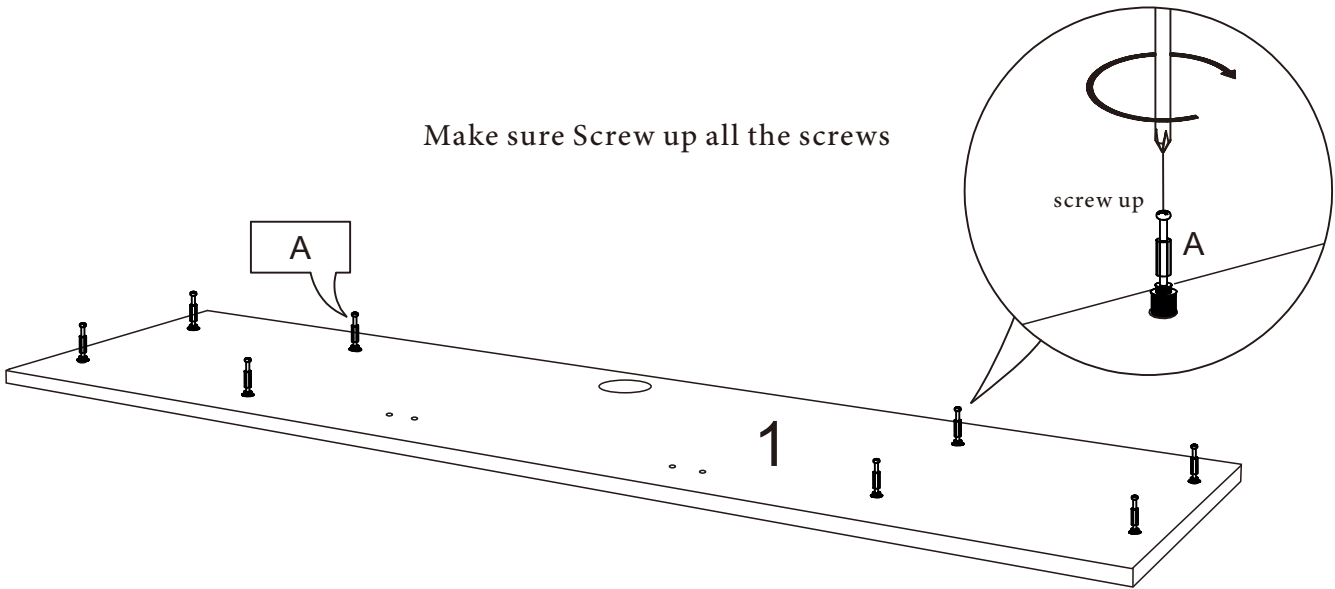

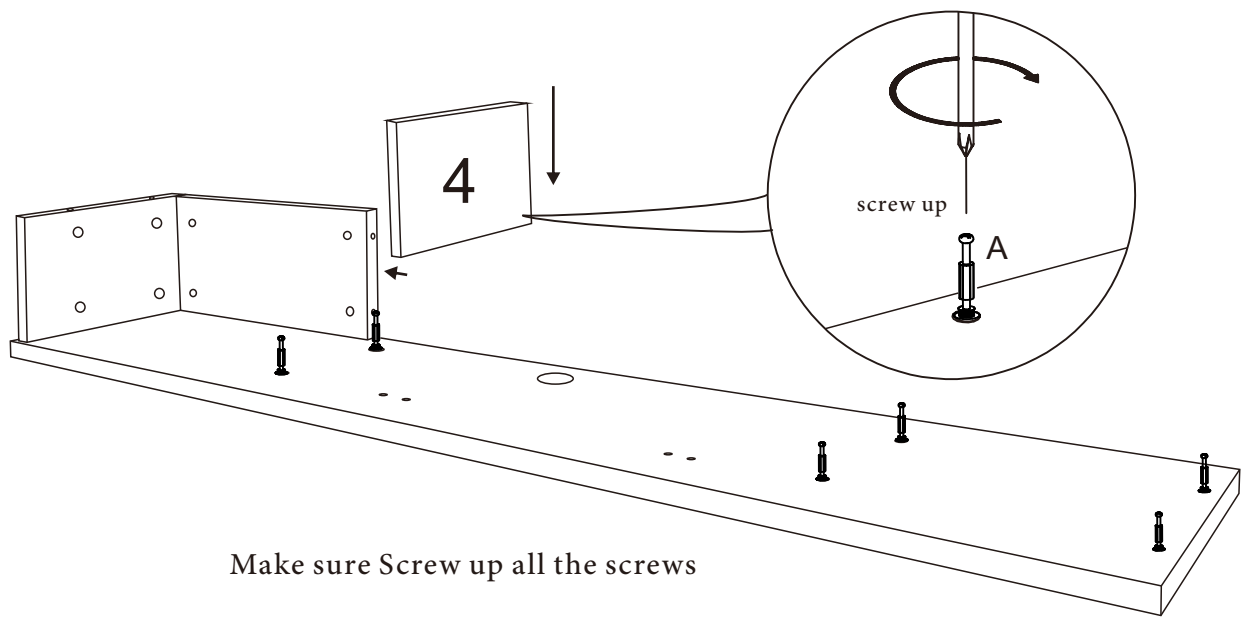

Make sure Screw up all the screws

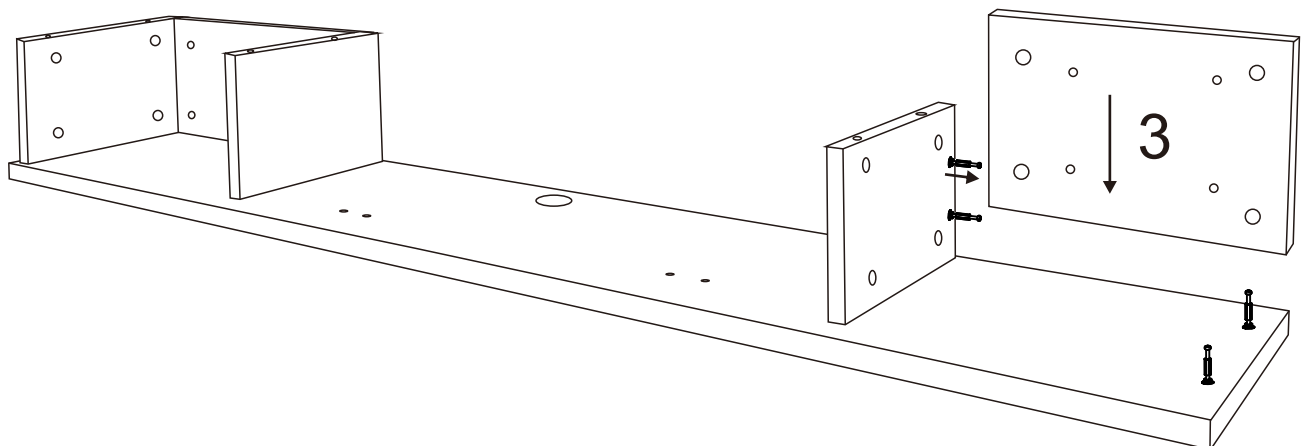
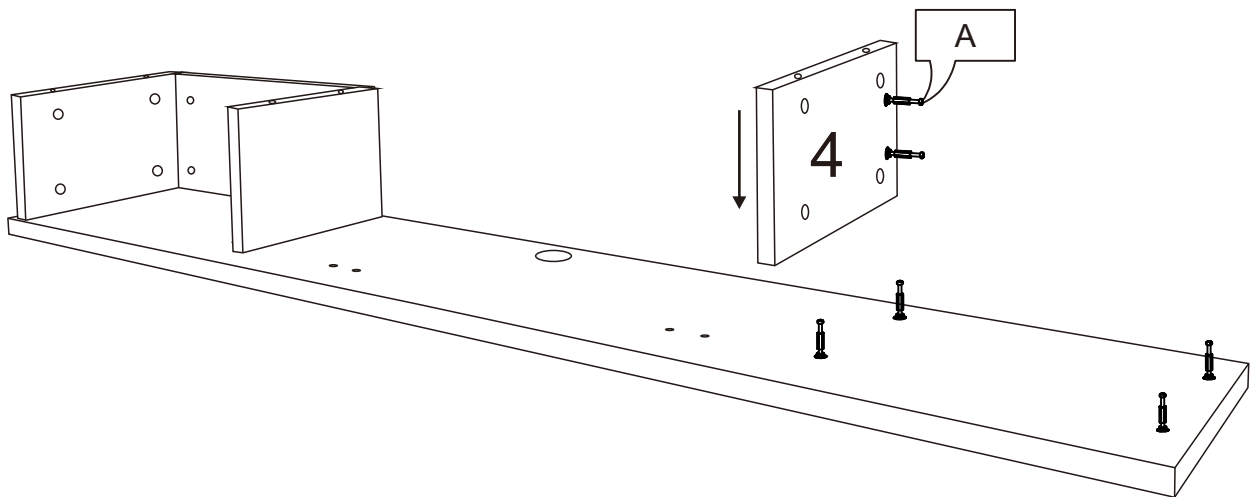

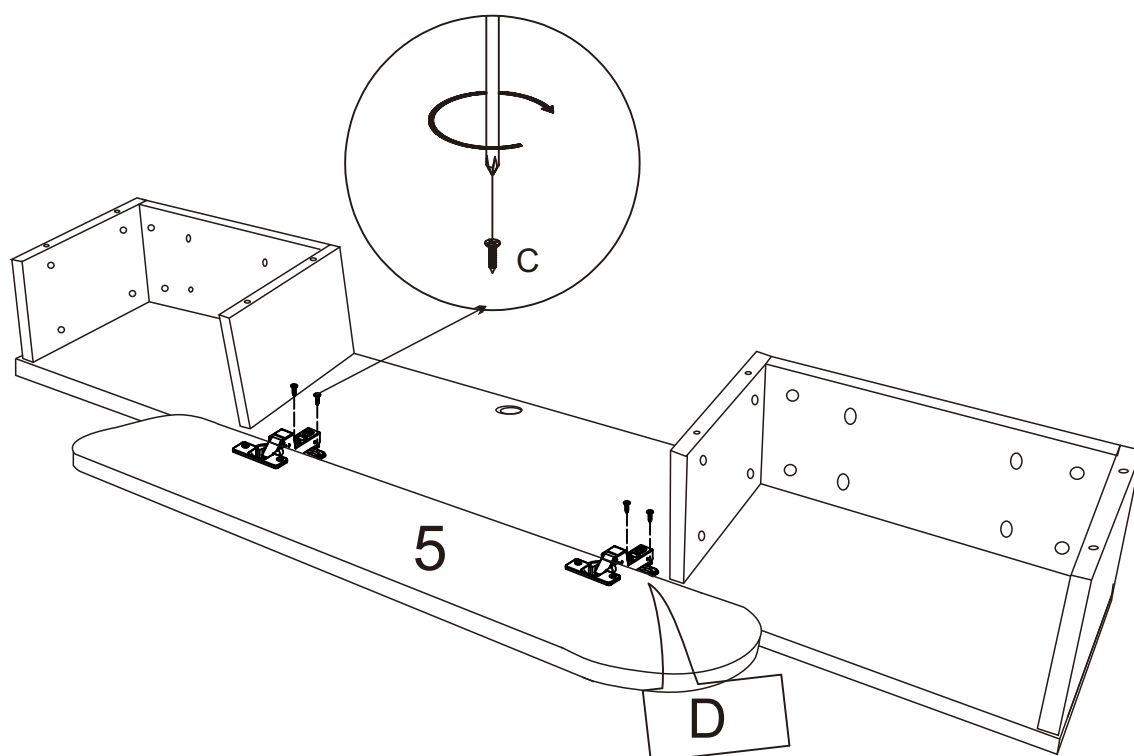
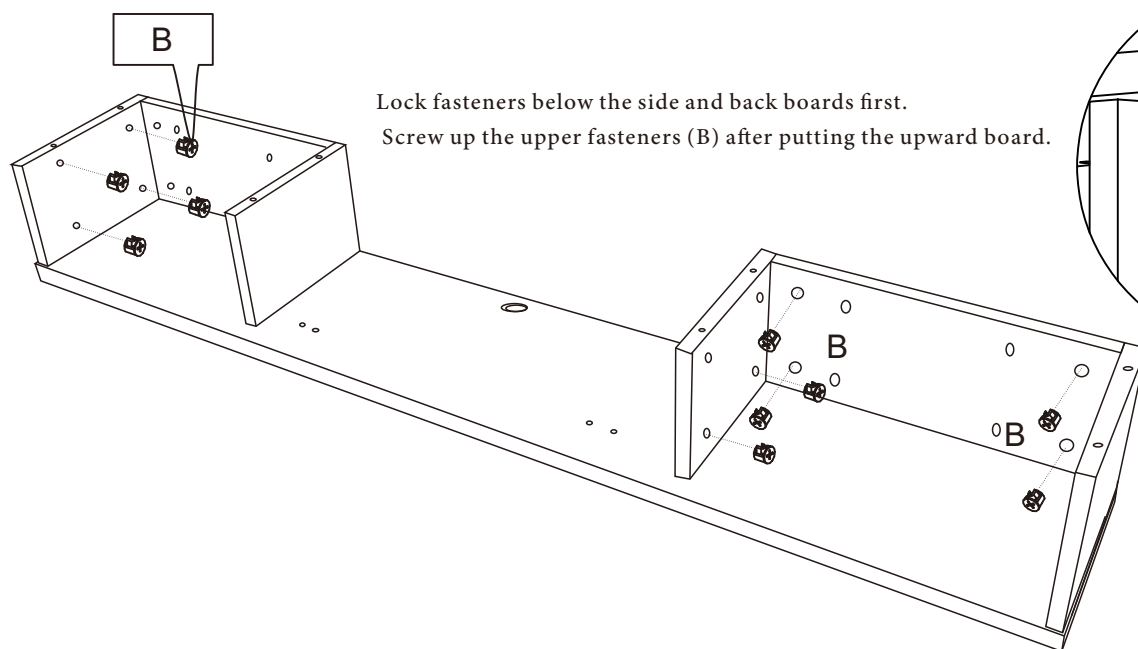
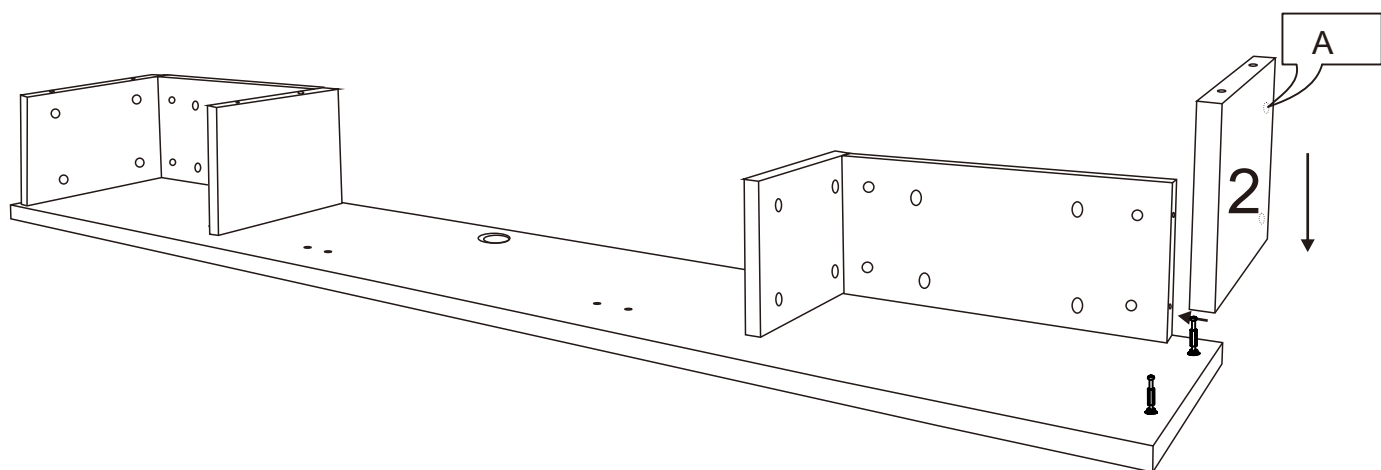

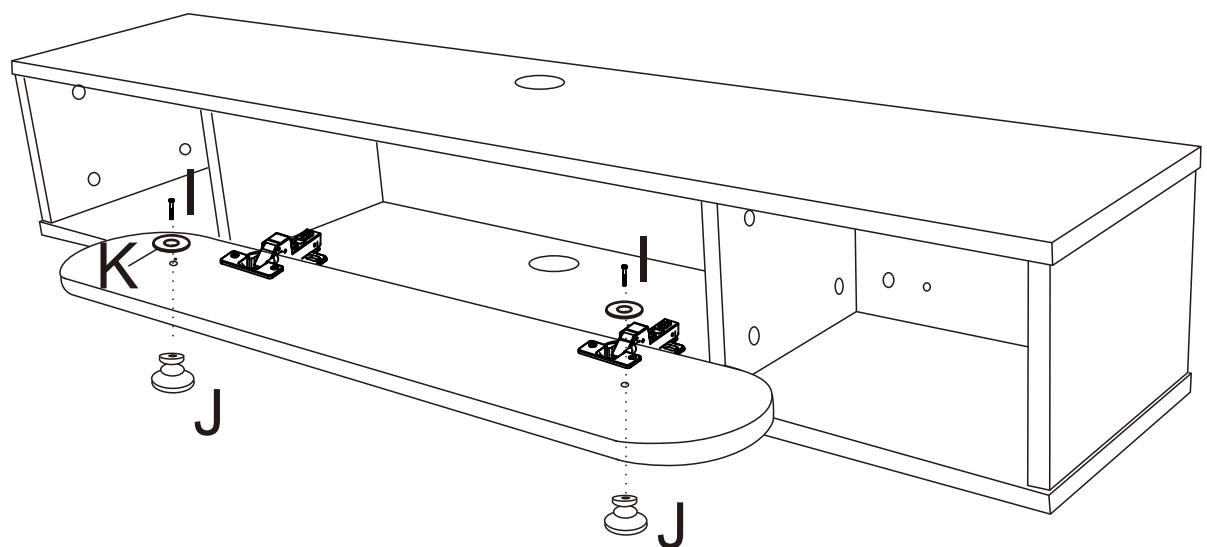
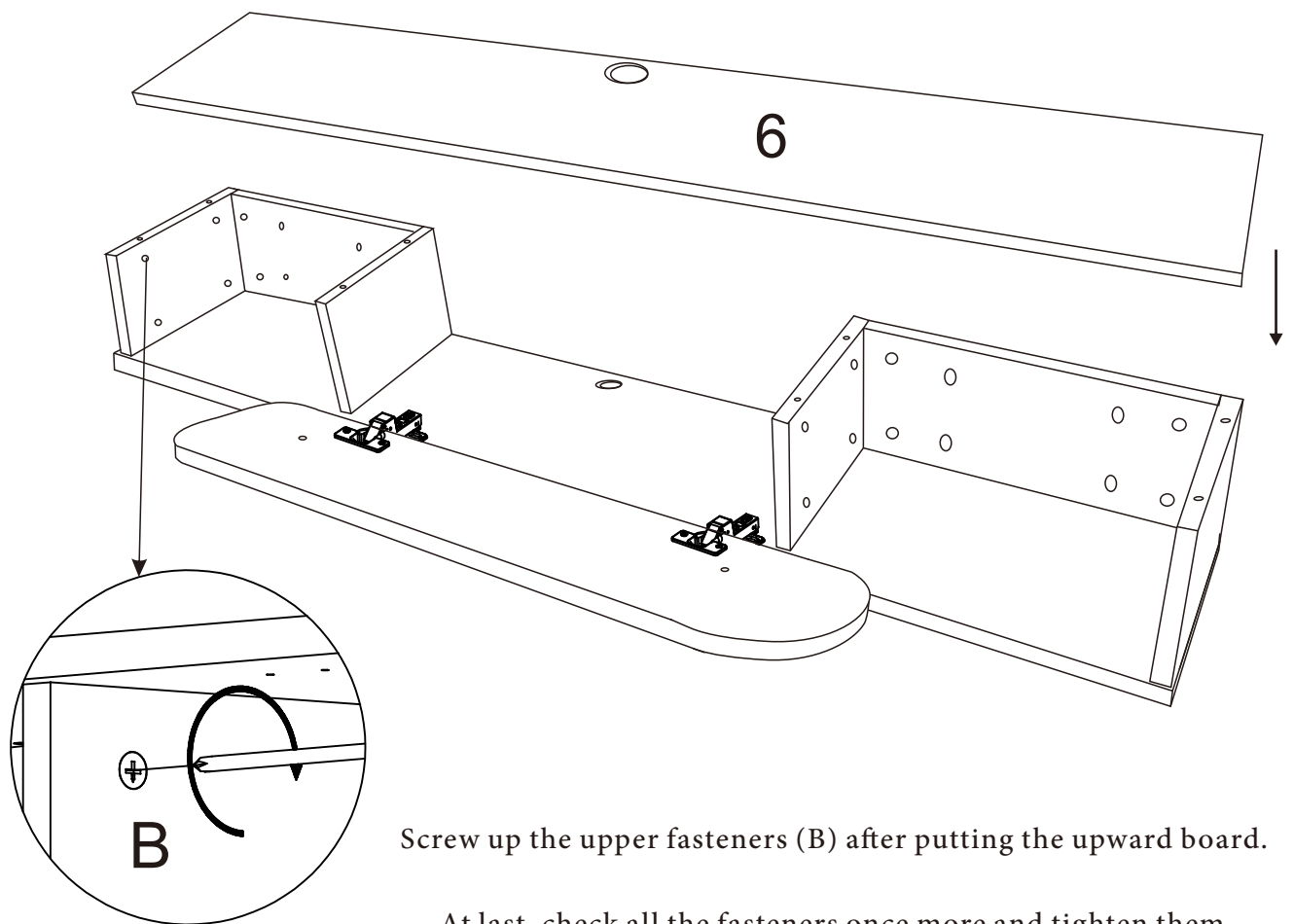

baseboard

Locate the hole on
the wall of the
furniture according
to the position of
the spirit level

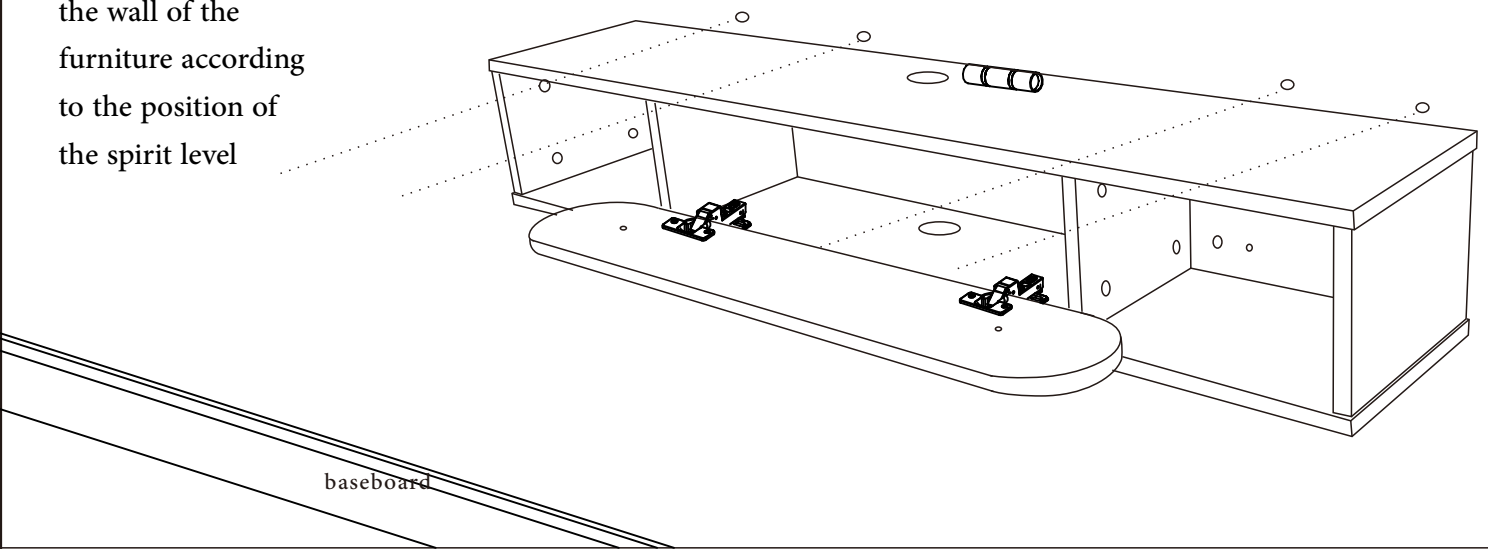

Drill 8mm holes on the wall according to the pre-holes

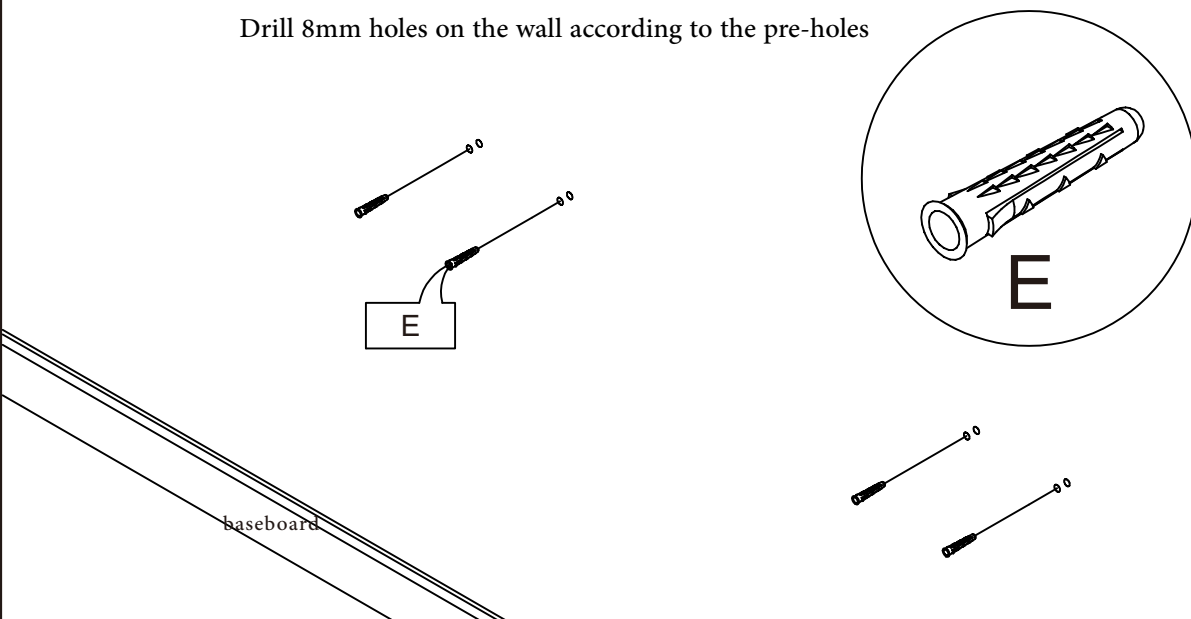

If you have drywall, please use replacement parts G and H to mount it on the wall
(check the steps on page 1)

Tools Recommended For Assembly : Power screwdriver

