

# A31-Installation Instructions

( Please refer to the installation video on the product link, or the installation video on YouTube,  
or feel free to contact us directly on Amazon. )

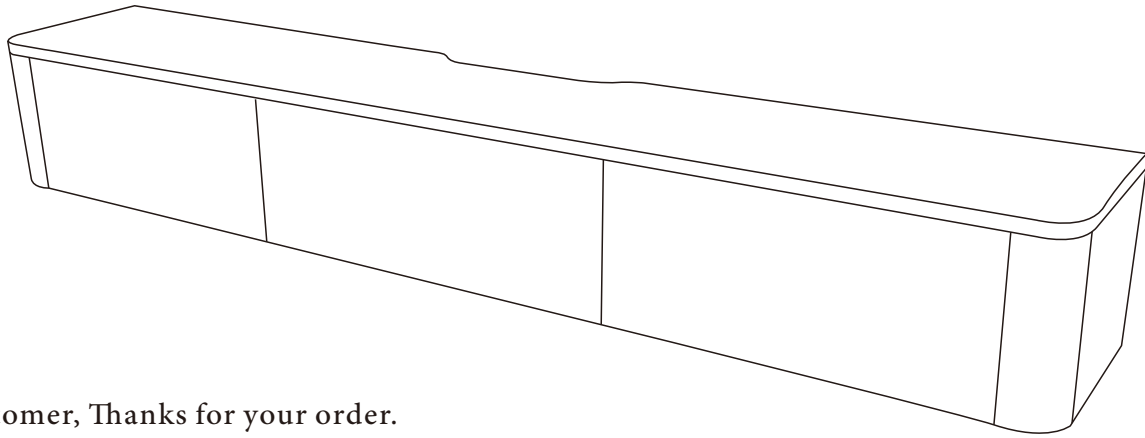

Dear customer, Thanks for your order.  
If you have any questions.  
please feel free to contact us directly.

Included 8mm screws and anchors  
for solid brick walls.  
load-bearing walls.  
and fired hollow brick walls

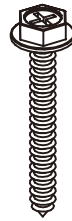

If you have drywall, please use the  
18mm drill bit(not included) and the  
toggle bolts for mounting (package included).  
Follow the steps below for mounting on the drywall

- Step 1: Drill 18mm hole on the drywall
- Step 2: Getting through the pre-holes of the tv stand with G & H
- Step 3: Put the Wing Nut on the Toggle Bolt (G) and then pass it through the hole of the drywall
- Step 4: Put all the toggle bolts and butts into the drywall
- Step 5: Screw up all the toggle bolts



step1



step2

Recommended Number of People for Assembly 2.

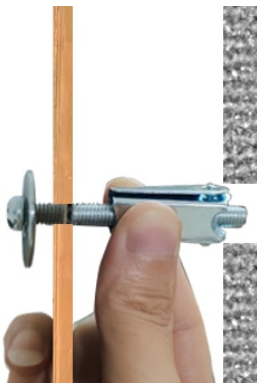

step3

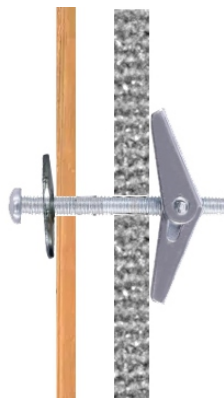

step4



step5

## Tools Included

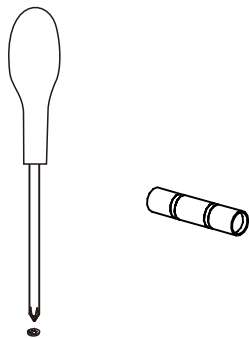

## Tools Required



### How to adjust the door hinge/hinge.

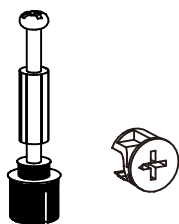
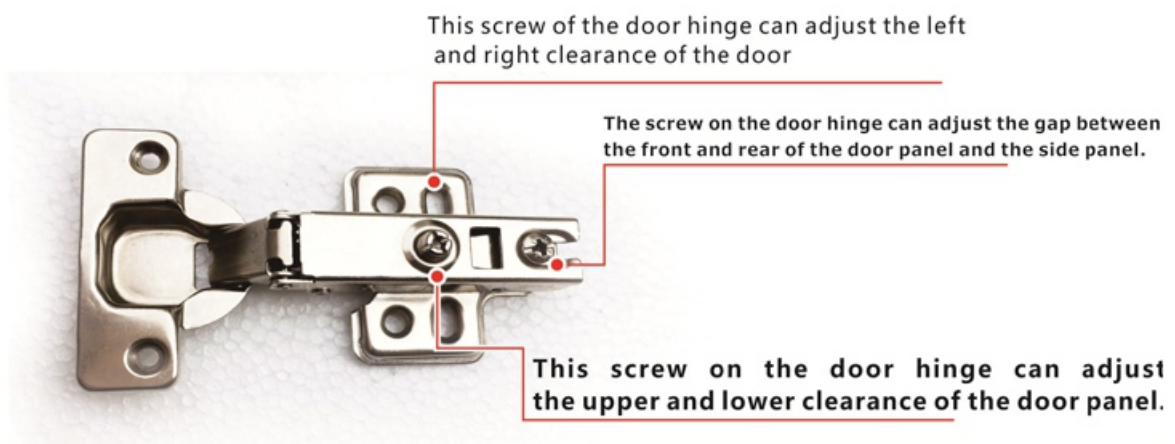

3-in-1 fastener screws

Unscrew it to the left and screw it to the right

put the 3-in-1 screws into the pre-holes and then screw them with screwdriver or power screwdriver

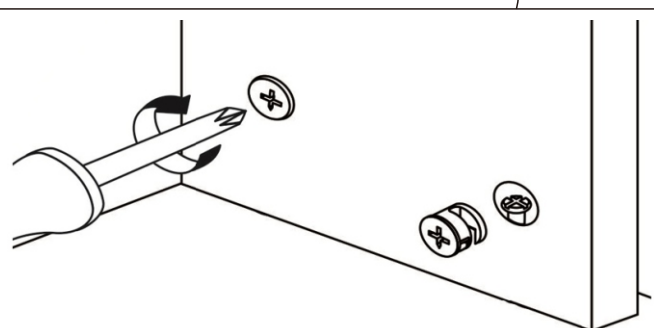
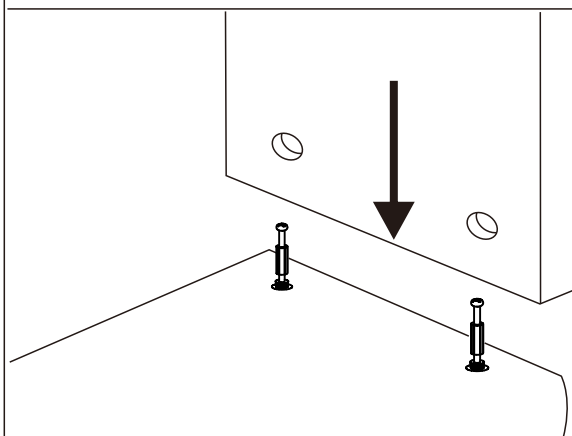

put the fasteners into the holes and screw it with a screwdriver

If the door is uneven once assembled, you can adjust the hinges like following

Adjust left

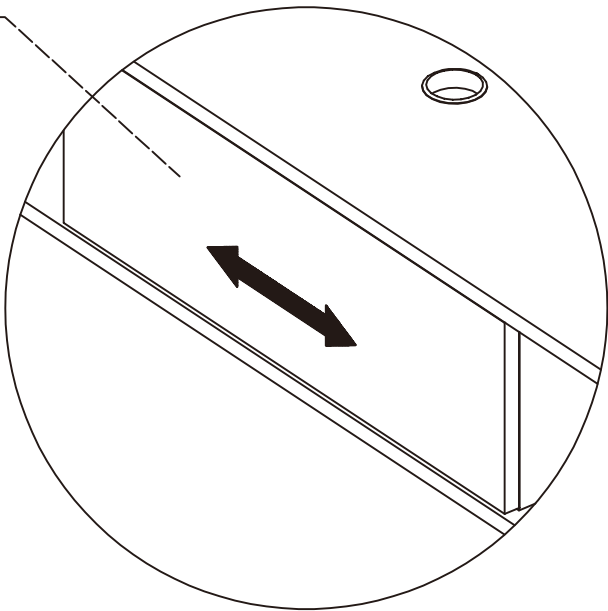
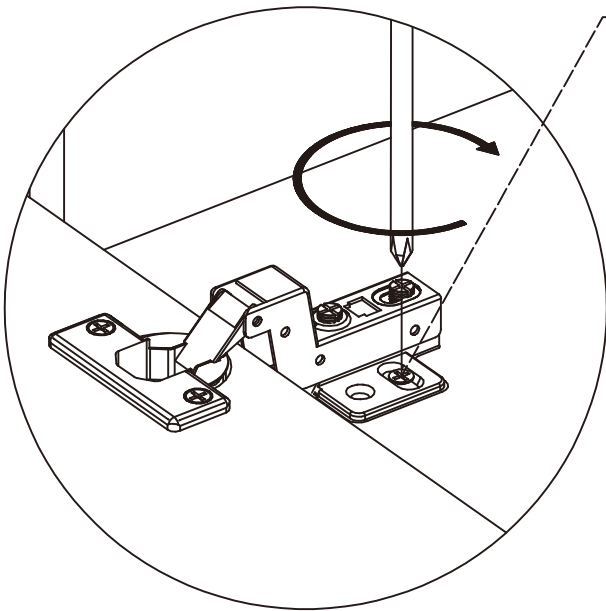

Adjust Height

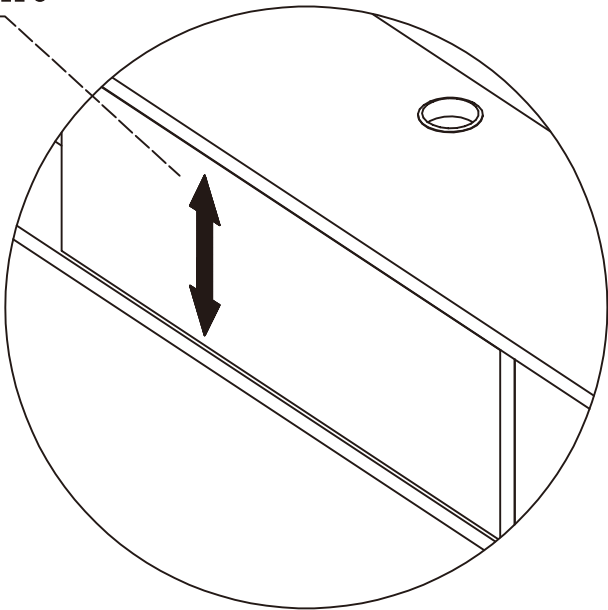
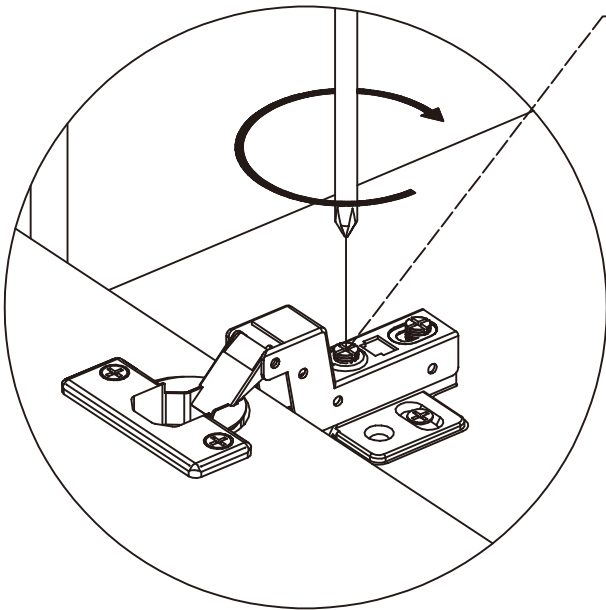

Adjust front

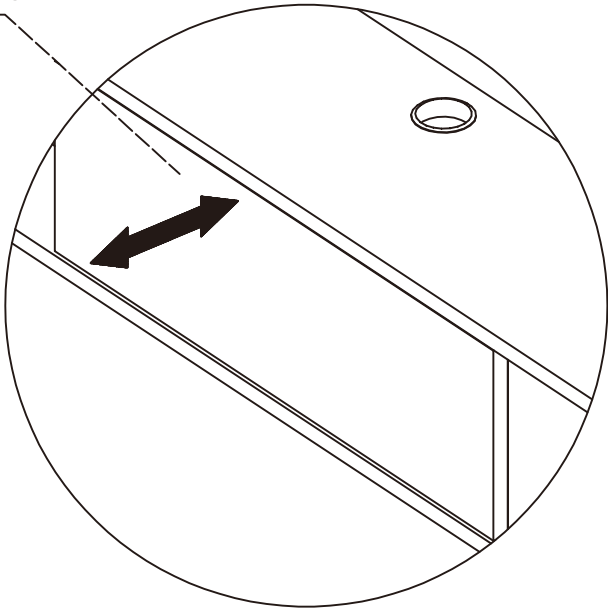
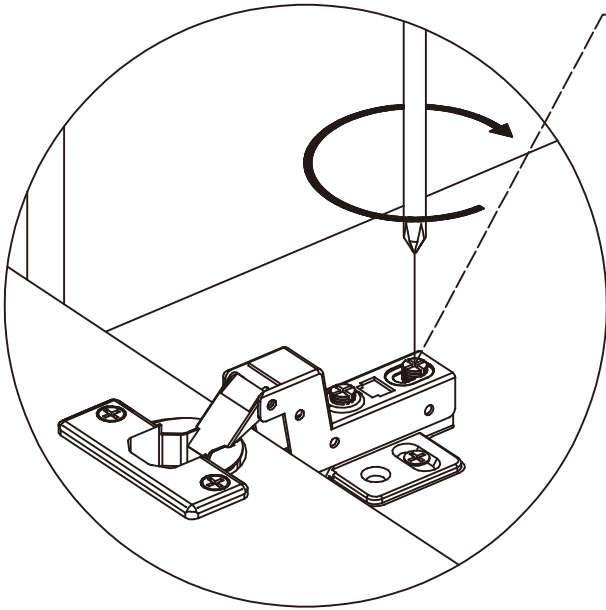

package Included

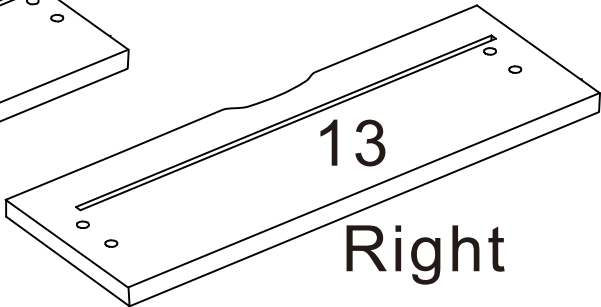
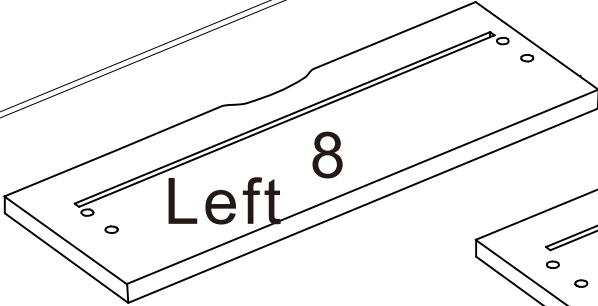
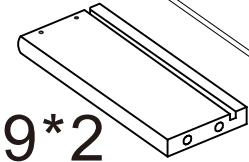
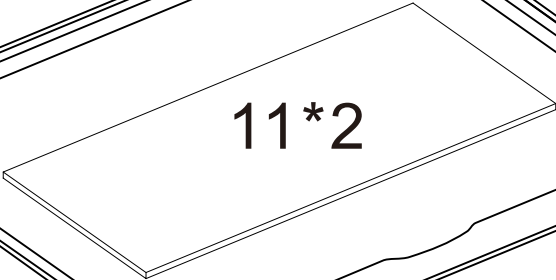
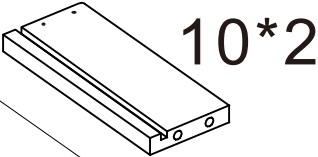
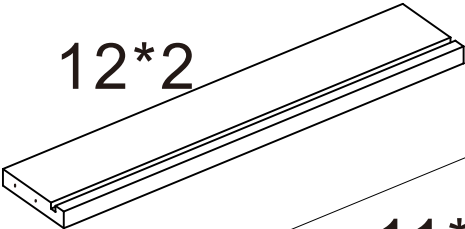
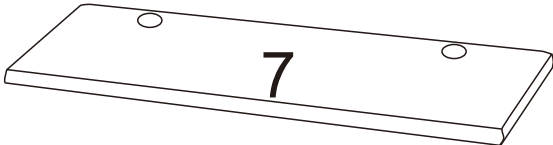
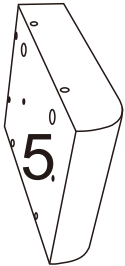
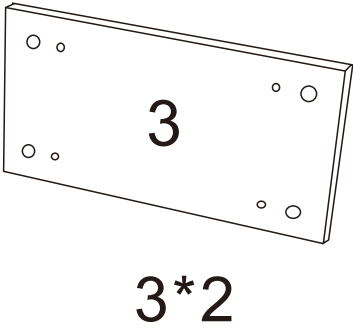
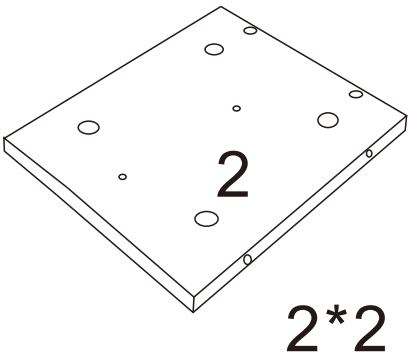
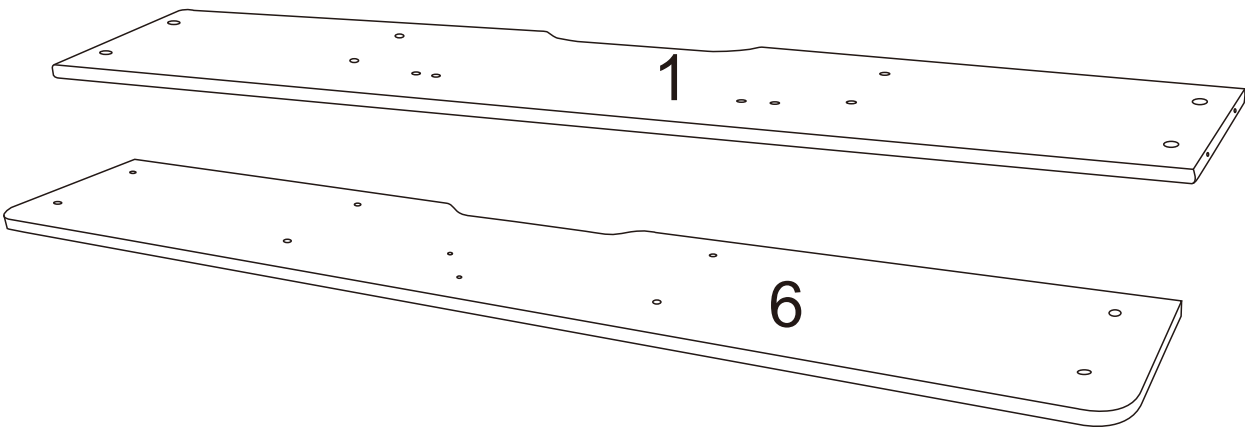



## package Included

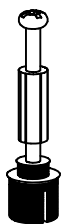

A\*32



B\*32



C\*30

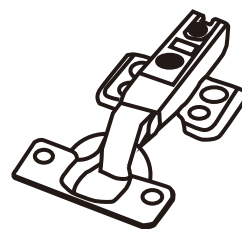

D\*2



E\*8

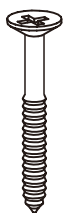

F\*8

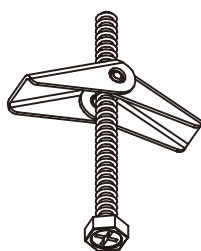

G\*8



H\*8

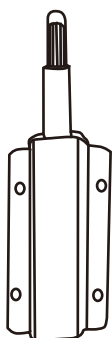

I\*1

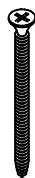

J\*8

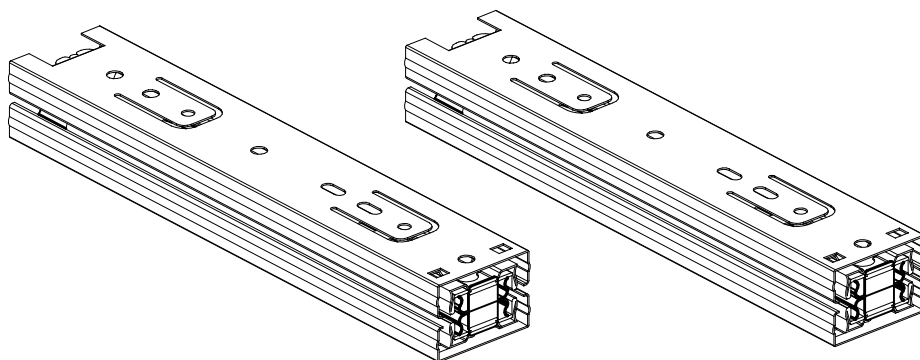

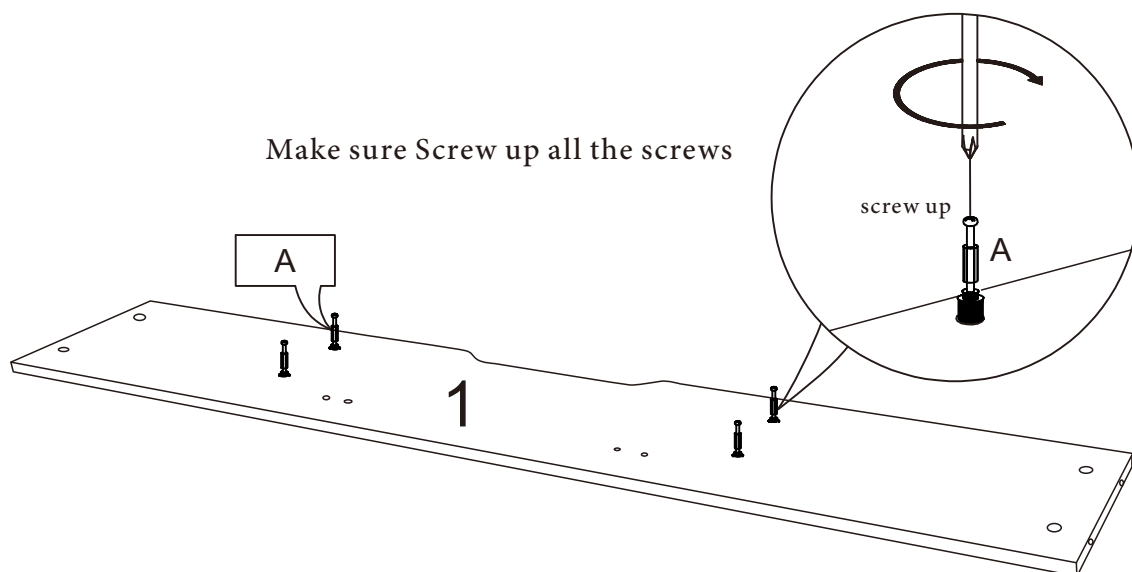

The sliding rails need to be separated before installation.

### Product component installation sequence diagram

① Stretch the slide rail to the maximum.

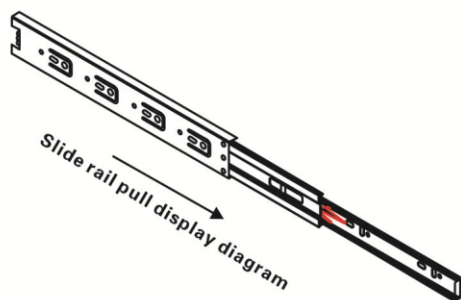

② Press and hold the button to remove the slide rail.

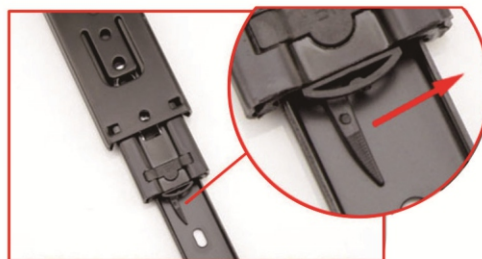

The rail can be removed by sliding in the direction of the arrow  
No tools required

③ Fold the slide rail into two parts A \ B.

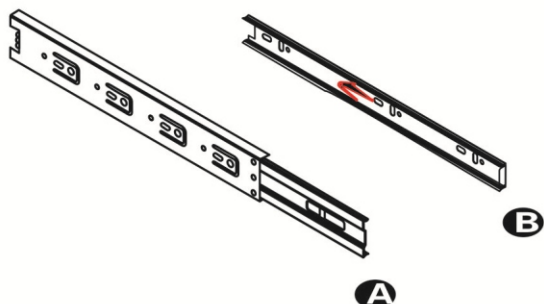

④ Fix A slide rail with small tapping screws No. 2\3 board.

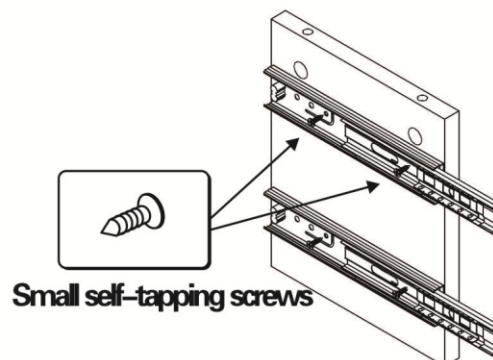

Attention the screw holes directions  
Attention the directions of drawer slide

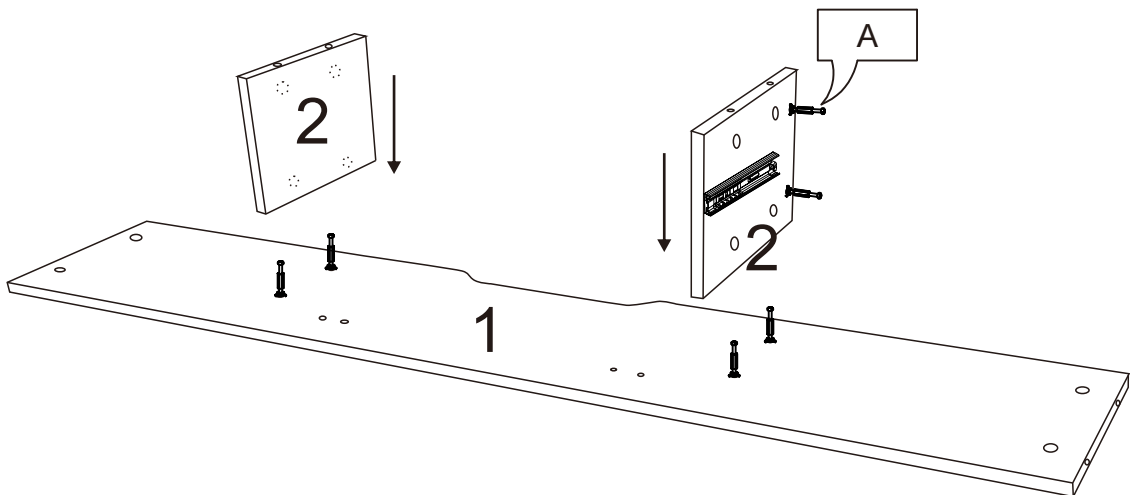
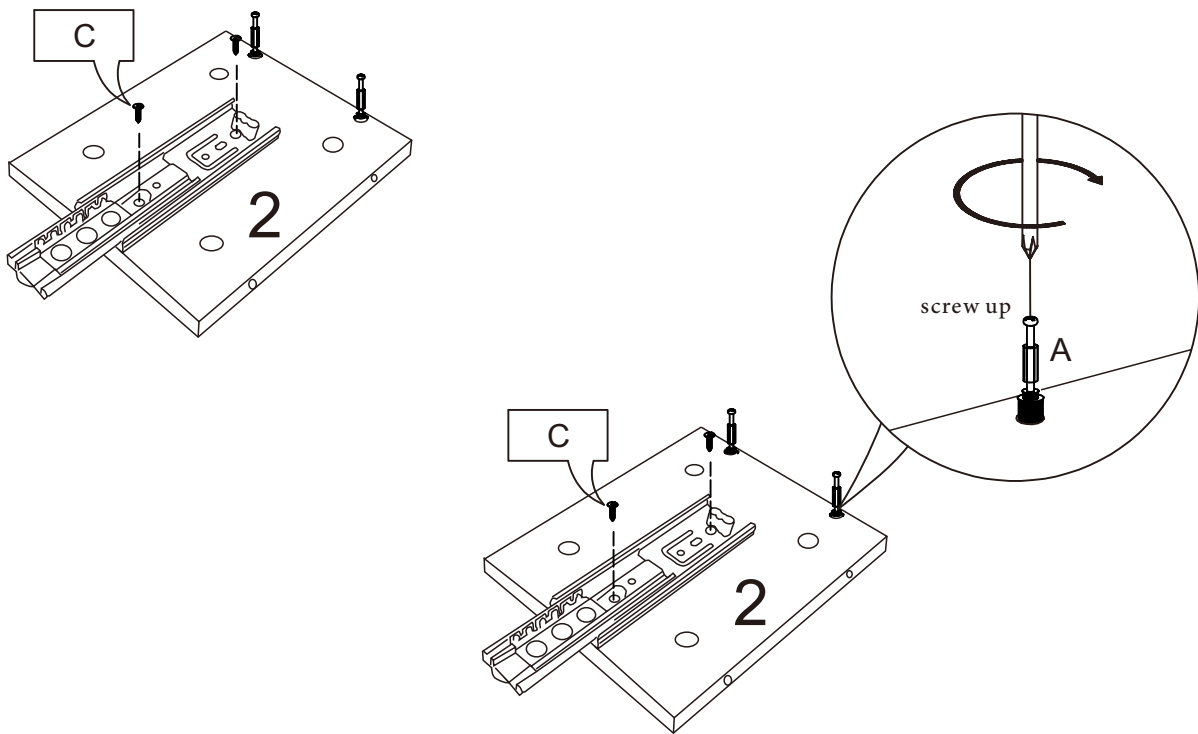

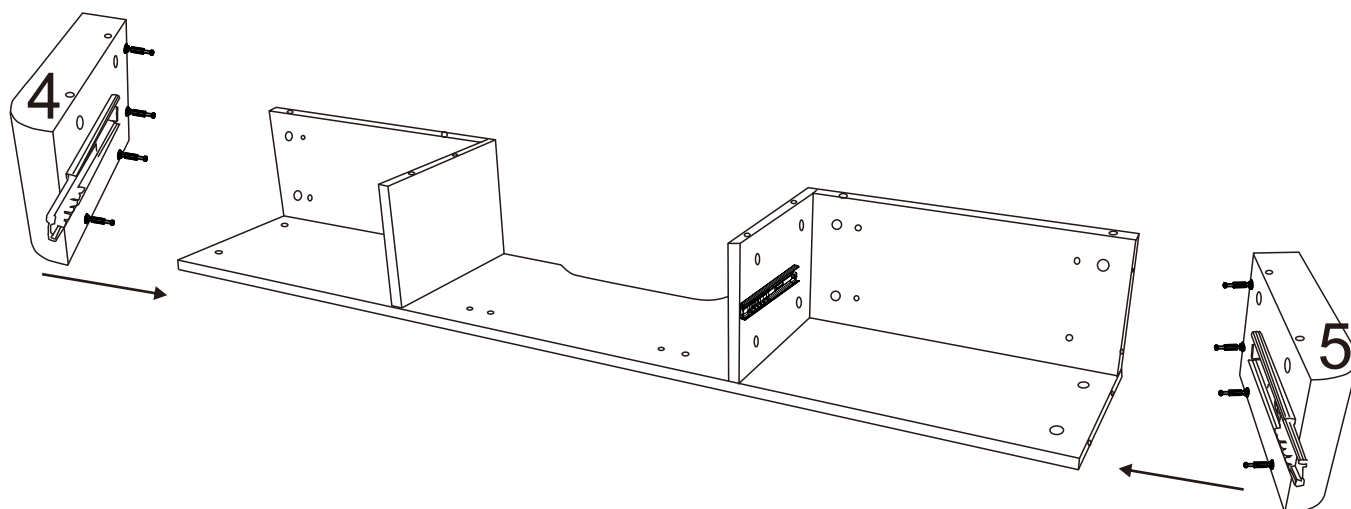
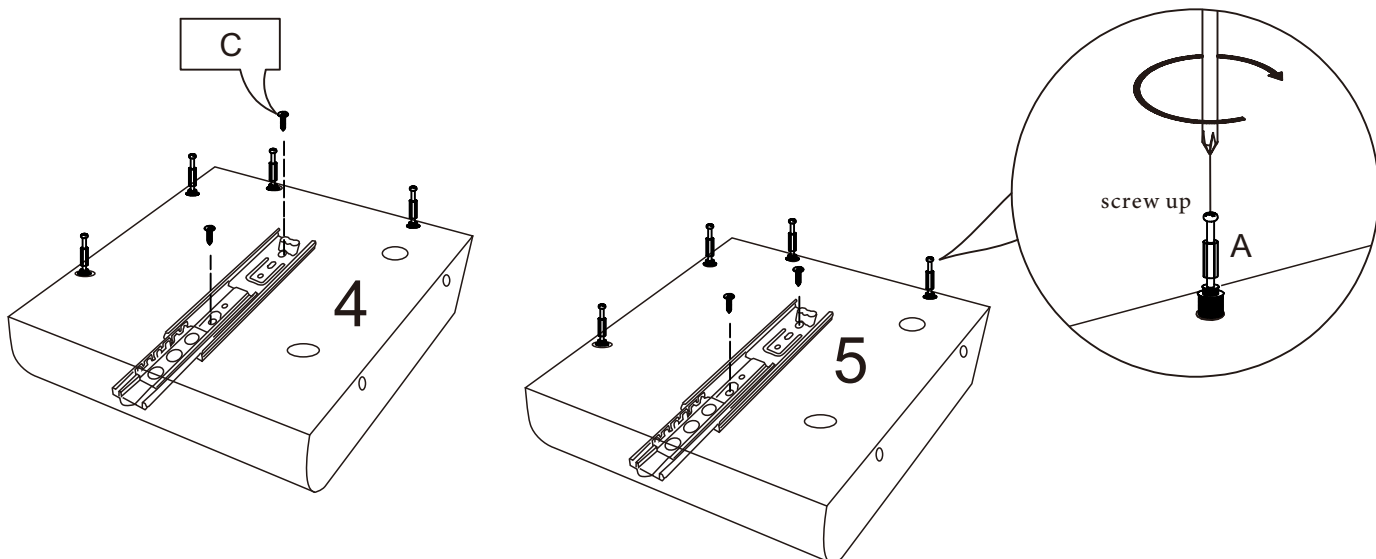
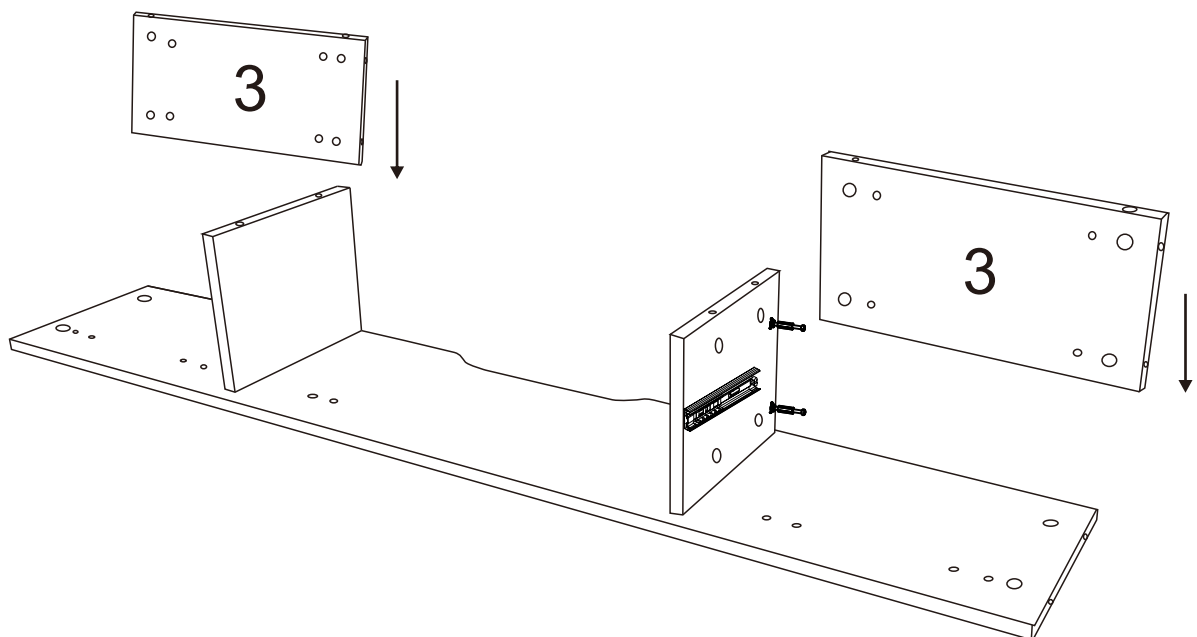

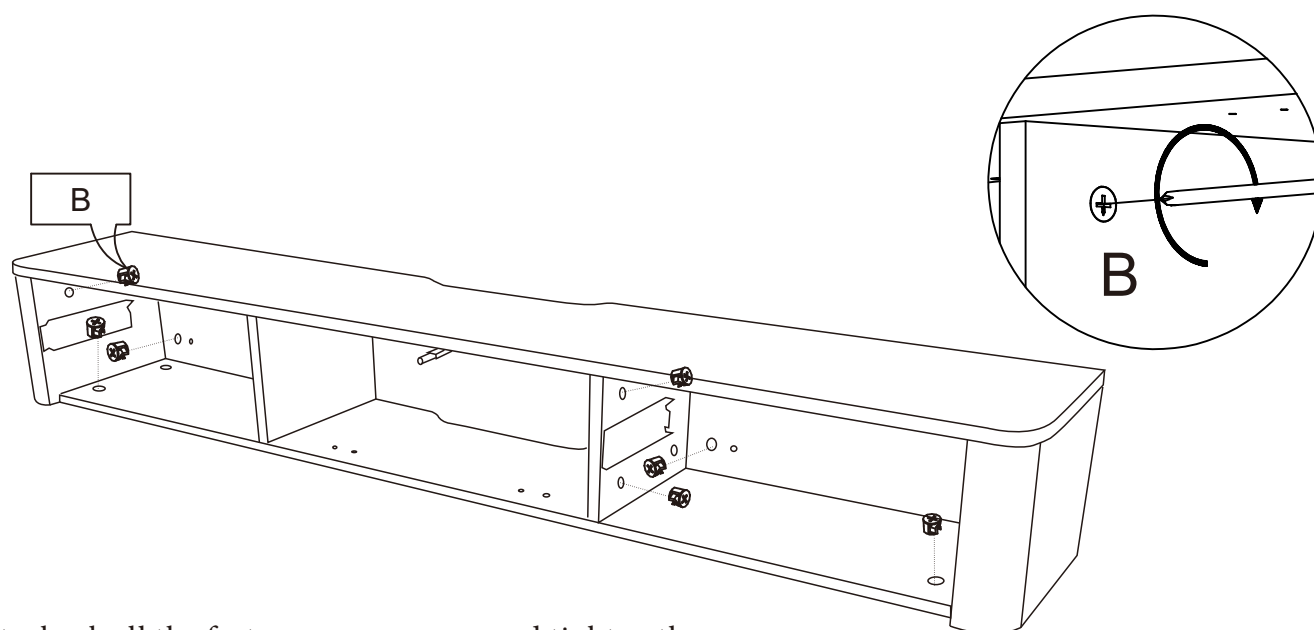
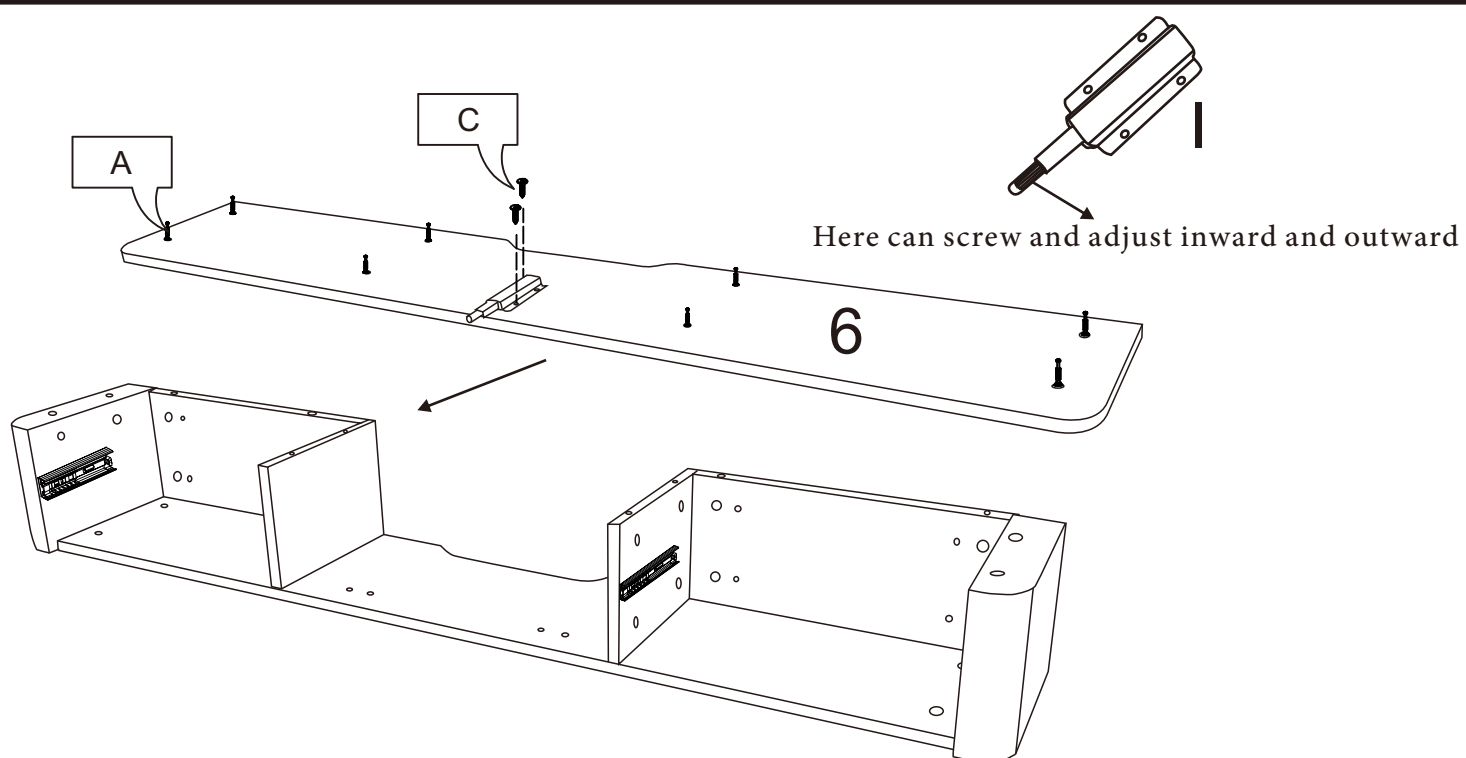

At last, check all the fasteners once more and tighten them.

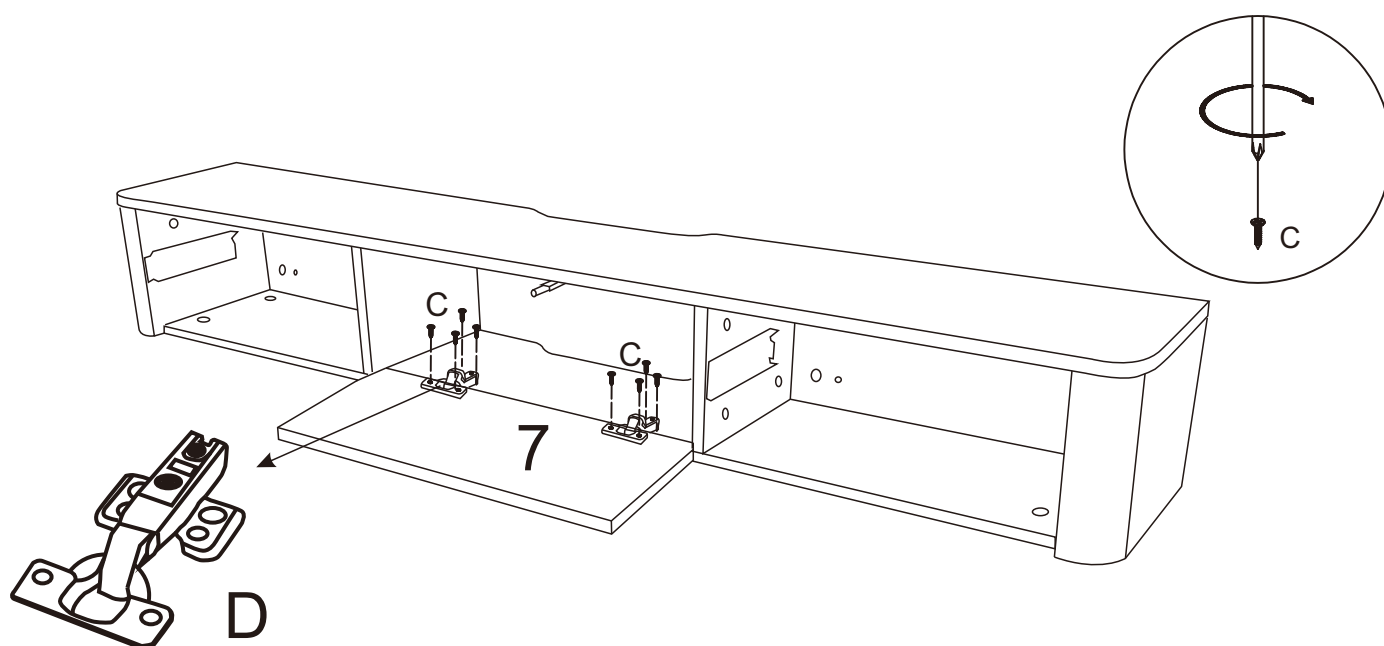

Locate the hole on  
the wall of the  
furniture according  
to the position of  
the spirit level

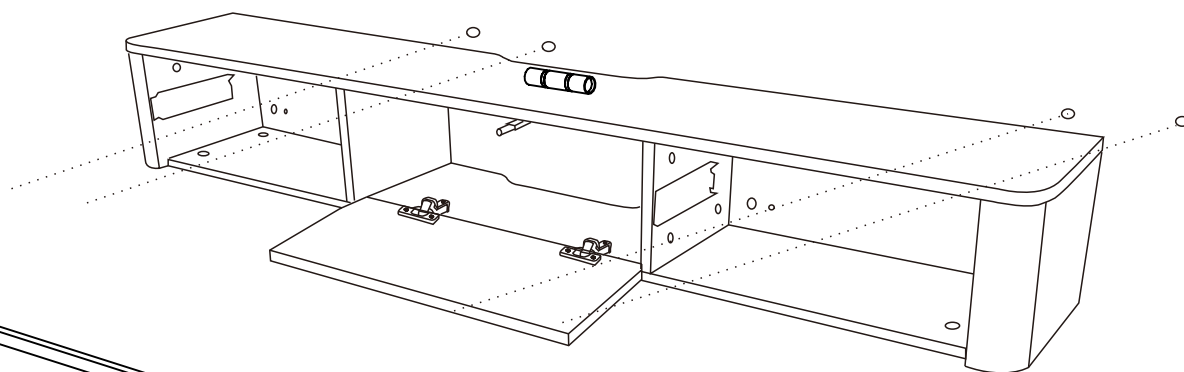

baseboard

Drill 8mm holes on the wall according to the pre-holes

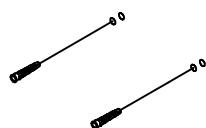
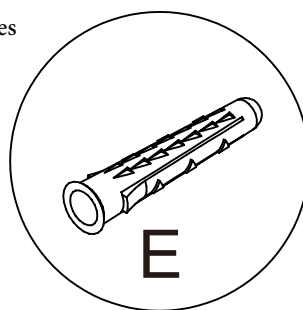
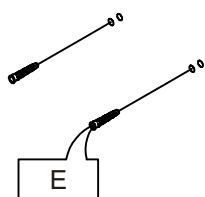

baseboard

If you have drywall, please use replacement parts G and H to mount it on the wall  
( check the steps on page 1)

Tools Recommended For Assembly : Power screwdriver

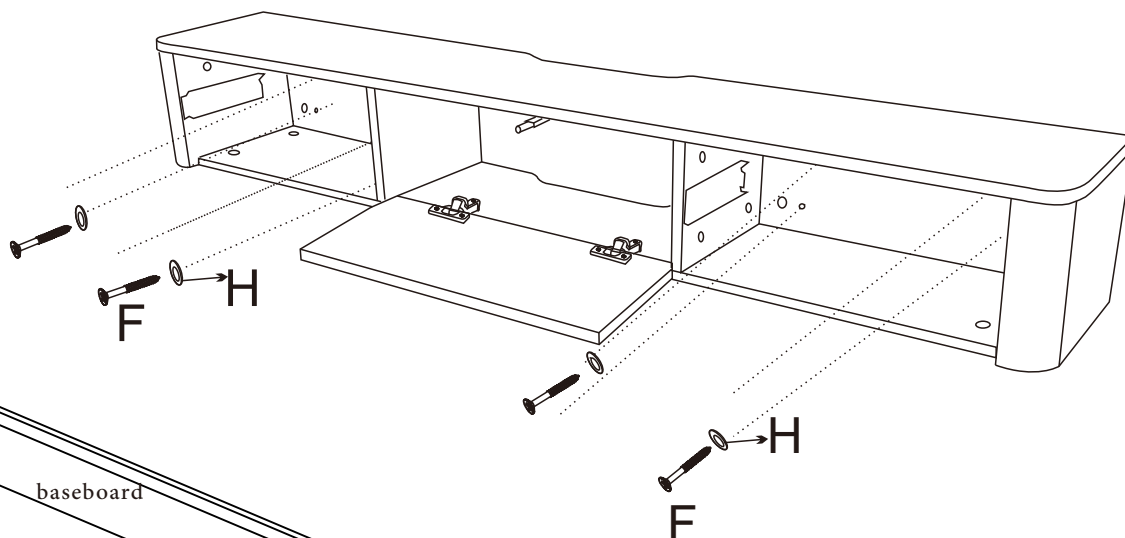

baseboard

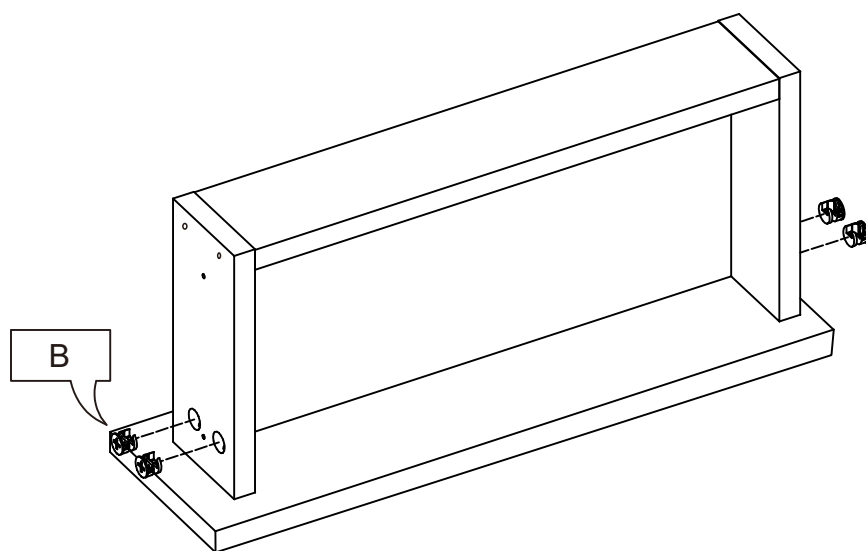
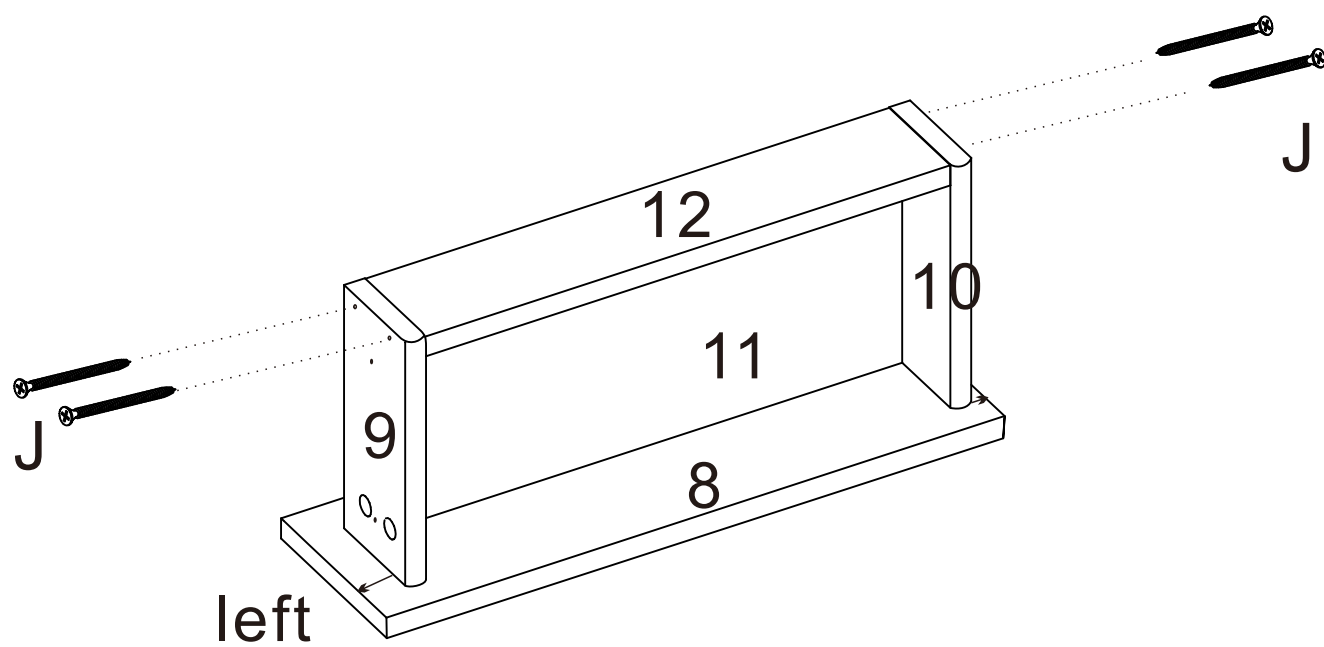
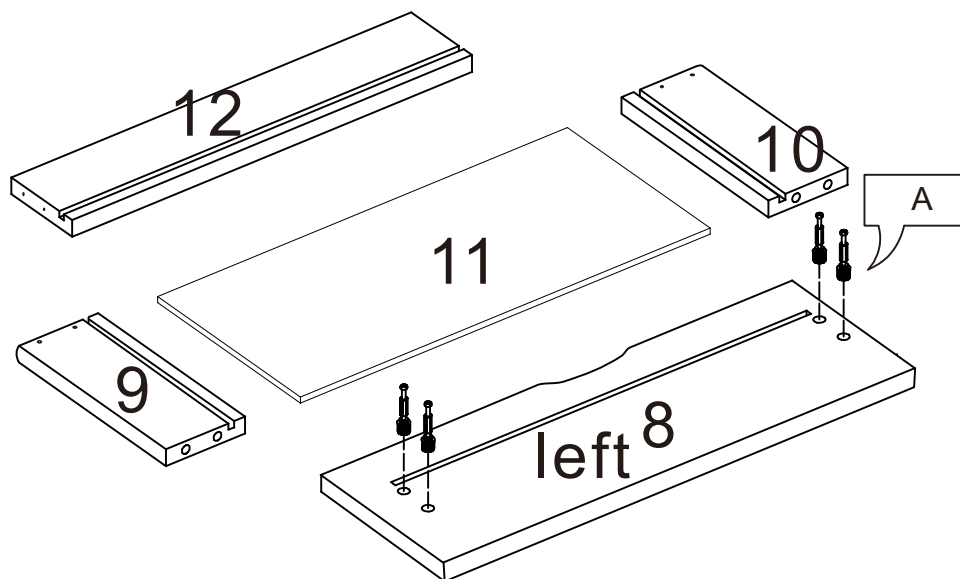



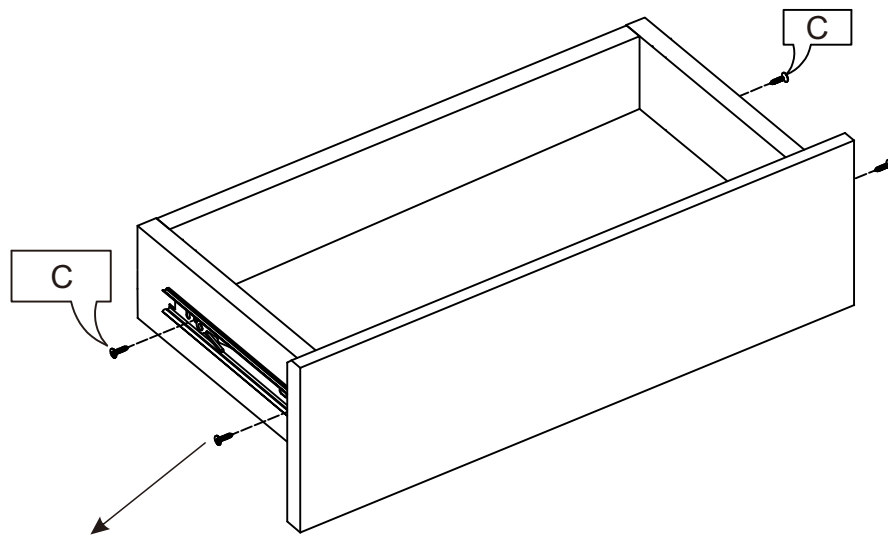

Attention the directions of drawer slide  
Here C is at the second hole

